

DETAIL1

DETAIL1



SIM WITH CARD

RECOMMENDED PCB LAYOUT

NOTES:

- MATERIAL:
HOUSING: LCP, GLASS-FILLED, UL 94V-0, COLOR ,BLACK.
TERMINAL: 0.12MM PHOSPHOR BRONZE.
SHELL: STAINLESS STEEL.
- FINISH:
TERMINAL CONTACT AREA: 10μ" GOLD PLATING OVERALL 1.25 MICRON NICKEL MIN.
TERMINAL SOLDER AREA: GOLD FLASH OVERALL 1.25 MICRON NICKEL MIN.
SHELL: GOLD FLASH OVER SOLDERING PAD, 2.0 MICRON NICKEL MIN. OVERALL
- COPLANARITY: 0.1MM MAX AMONG SOLDER TAILS AND FITTING NAILS.
- PRODUCT SPECIFICATION: PS-47273-001.
- PRODUCT COMPLIANT TO ROHS DIRECTIVE 2002/95/EC AND ELV DIRECTIVE 2000/53/EC

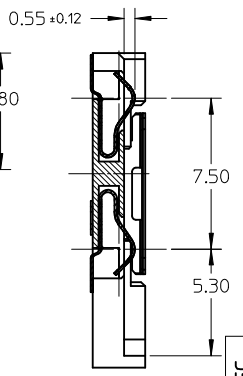
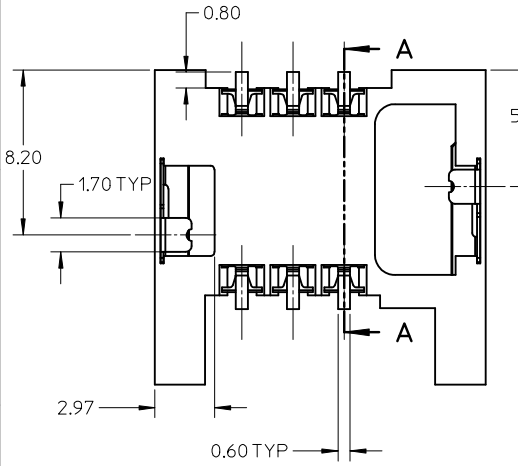

SECTION A-A

ITEM	NAME	MATERIAL NO.
1	HOUSING	472730002
2	TERMINAL	472738003
3	SHELL	472730004

UPDATED PLATING SPEC.	EC NO:	2009/09/01
	DRW:LL1010	2009/09/01
	CHKD:	2009/09/13
	APPR:MFDENG	2009/09/13
REV	A	

QUALITY SYMBOLS	DESCRIPTION
▽=0	
⊕=0	

GENERAL TOLERANCES (UNLESS SPECIFIED)	
	mm INCH
4 PLACES	± --- ± ---
3 PLACES	± --- ± ---
2 PLACES	± 0.2 ± ---
1 PLACE	± --- ± ---
ANGULAR ± 3 °	
DRAFT WHERE APPLICABLE MUST REMAIN WITHIN DIMENSIONS	

DIMENSION STYLE	
MM ONLY	
DRAWN BY	DATE
OYANG	2005-08-31
CHECKED BY	DATE
Y. J WU	2005-08-31
APPROVED BY	DATE
VINCENT	2005-08-31
MATERIAL NO.	
472738001	

SCALE	DESIGN UNITS	THIRD ANGLE PROJECTION
4:1	METRIC	
TITLE		
SIM CARD CONNECTOR SALES DRAWING		
MOLEX INCORPORATED		SHEET NO.
DOCUMENT NO.		1 OF 1
472738001		SD-47273-801
THIS DRAWING CONTAINS INFORMATION THAT IS PROPRIETARY TO MOLEX INCORPORATED AND SHOULD NOT BE USED WITHOUT WRITTEN PERMISSION		