

- NOTE:
1. MATERIAL:
HOUSING: LCP, GLASS FILLED, UL94V-0, COLOR: BLACK
TERMINAL & FITTING NAIL: COPPER ALLOY
PICK & PLACE CAP: NYLON, UL94V-0, COLOR: BLACK
 2. FINISHES:
CONTACT: 0.76µm MIN. SELECTIVE GOLD OVER
1.27µm MIN. NICKEL UNDERPLATE
SOLDERTAIL: 2.54µm MIN. TIN OVER
1.27µm MIN. NICKEL UNDERPLATE
 3. PRODUCT SPECIFICATION: PS-78795-001
 4. PACKAGING SPECIFICATION: PK-78795-001
 5. DATE CODE AND MOLEX LOGO TO BE LOCATED APPROXIMATELY AS SHOWN
 6. PRODUCT IS COMPLIANT TO RoHS DIRECTIVE WITH THE FOLLOWING BANNED SUBSTANCES -
LEAD, MERCURY, CADMIUM, HEXAVALENT CHROMIUM, POLYBROMINATED BIPHENYL AND POLYBROMINATED DIPHENYL ETHERS
 7. MATES WITH SFF-8482 PLUG, SFF-8680 PLUG
 8. ALL DESIGNATED GROUND PINS ARE A SINGLE RETURN PATH

THIS DESIGN IS BASED ON DESIGN OBJECTIVES AND IS STRICTLY TENTATIVE. IT MAY CHANGE BASED ON RESULTS OF ADDITIONAL DESIGN REVIEWS & VERIFICATIONS.

ADD NOTE 8 EC NO: S2013-0732 DRWNG: GMENARLY 2013/04/18 CHKD: SCHEONG 2013/05/02 APPR: BOKOK 2013/05/03	QUALITY SYMBOLS	GENERAL TOLERANCES (UNLESS SPECIFIED)		DIMENSION STYLE		SCALE	DESIGN UNITS	THIRD ANGLE PROJECTION	
	$F_A=0$	mm	INCH	MM ONLY		NTS	METRIC		
	$F_G=0$	4 PLACES	± ---	± ---	DRAWN BY	DATE	TITLE		
	$F_P=0$	3 PLACES	± ---	± ---	CHECKED BY	DATE	SALES DRAWING		
	2 PLACES	± 0.20	± ---	APPROVED BY	DATE	SAS RECEPTACLE			
	1 PLACE	± ---	± ---	BOKOK	2012/11/16	VERTICAL MOUNT, SMT			
	0 PLACE	± ---	± ---	MATERIAL NO.		DOCUMENT NO.		SHEET NO.	
	ANGULAR ± 3 °		78795-0001		SD-78795-001		1 OF 3		
	DRAFT WHERE APPLICABLE MUST REMAIN WITHIN DIMENSIONS		THIS DRAWING CONTAINS INFORMATION THAT IS PROPRIETARY TO MOLEX INCORPORATED AND SHOULD NOT BE USED WITHOUT WRITTEN PERMISSION						

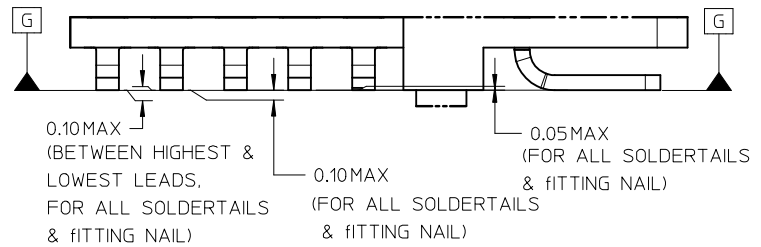
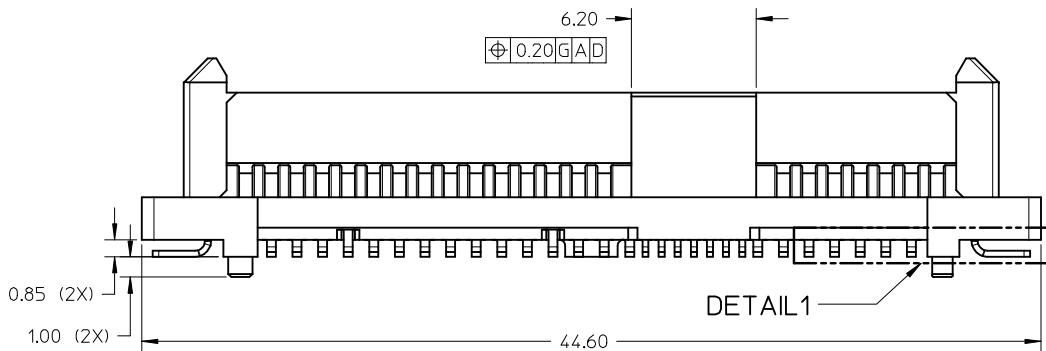

DETAIL1

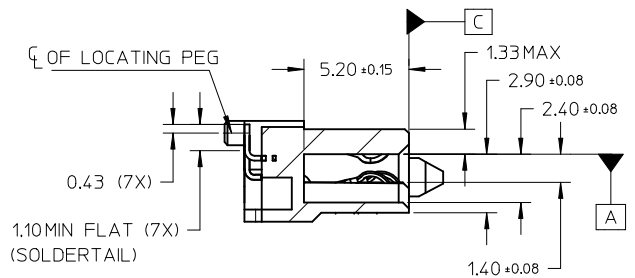
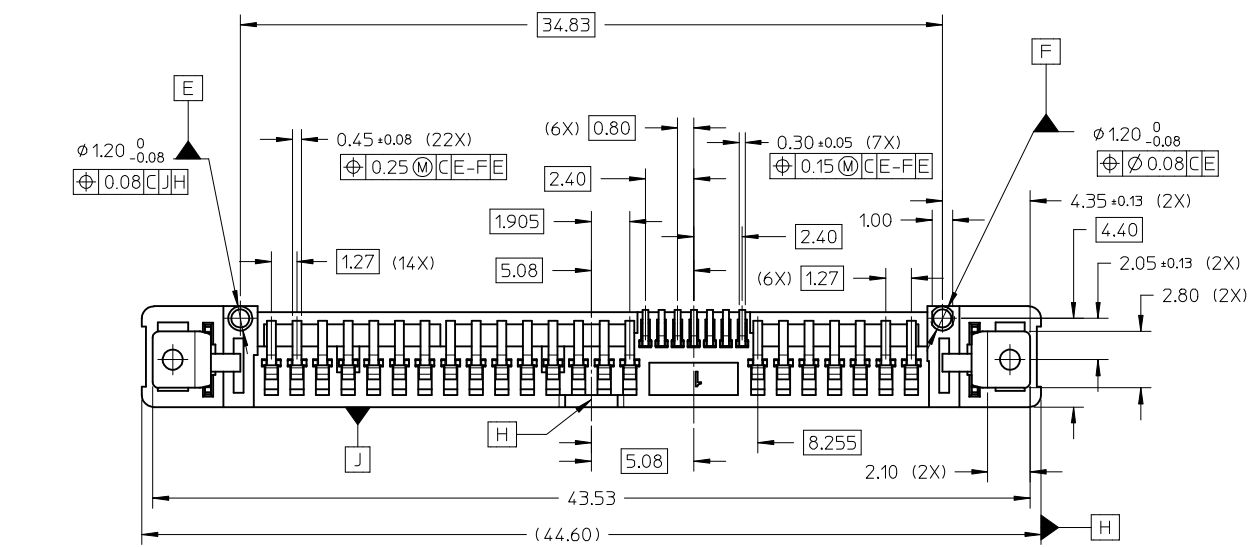

SECTION Z-Z

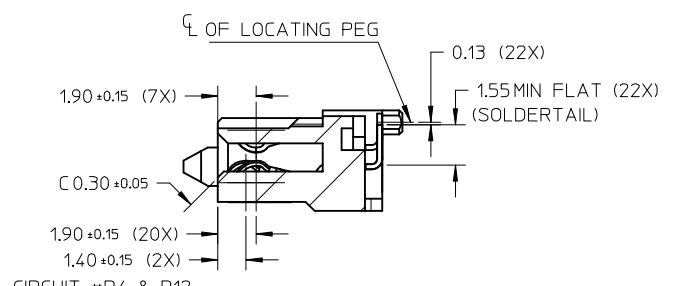

SECTION Y-Y

CIRCUIT #P4 & P12 ONLY (GROUNDS)

SEE SHEET 1 EC NO: S2013-0732 DRW:GMENARLY 2013/04/18 CHKD:SCHEONG 2013/05/02 APPR:BOKOK 2013/05/03	QUALITY SYMBOLS	GENERAL TOLERANCES (UNLESS SPECIFIED)	DIMENSION STYLE	SCALE	DESIGN UNITS	THIRD ANGLE PROJECTION
	$F_A=0$ $F_C=0$ $F_P=0$	mm INCH 4 PLACES ± --- ± --- 3 PLACES ± --- ± --- 2 PLACES ± 0.20 ± --- 1 PLACE ± --- ± --- 0 PLACE ± --- ± ---	MM ONLY	NTS	METRIC	
	ANGULAR ± 3 ° DRAFT WHERE APPLICABLE MUST REMAIN WITHIN DIMENSIONS	DRAWN BY DATE GMENARLY 2012/10/11 CHECKED BY DATE SCHEONG 2013/01/16 APPROVED BY DATE BOKOK 2012/11/16	TITLE	SALES DRAWING SAS RECEPTACLE VERTICAL MOUNT, SMT		
	MATERIAL NO. 78795-0001	DOCUMENT NO. SD-78795-001	SHEET NO. 2 OF 3	molex		

10 9 8 7 6 5 4 3 2 1

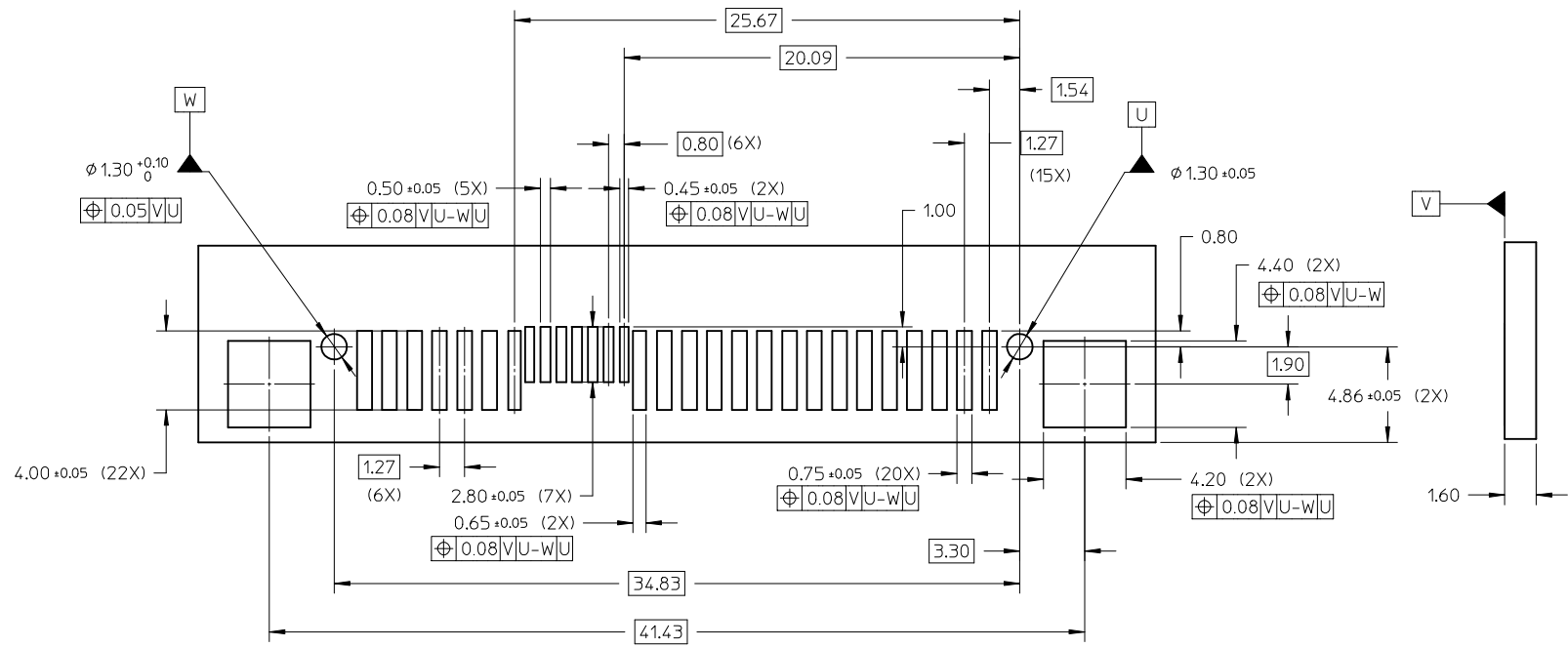

RECOMMENDED PCB LAYOUT

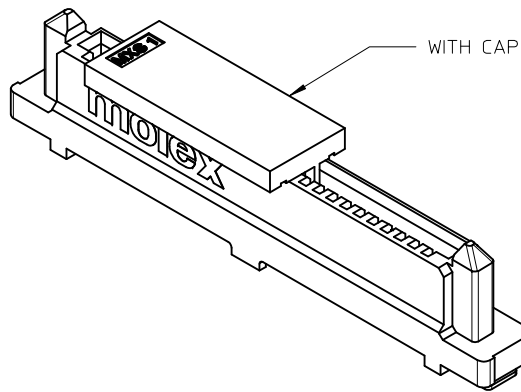

SEE SHEET 1 EC NO: S2013-0732 DRWN:GMENARLY 2013/04/18 CHKD:SCHEONG 2013/05/02 APPR:BOKKOK 2013/05/03	QUALITY SYMBOLS	GENERAL TOLERANCES (UNLESS SPECIFIED)		DIMENSION STYLE MM ONLY		SCALE NTS	DESIGN UNITS METRIC	THIRD ANGLE PROJECTION	
	$F_A=0$ $F_G=0$ $F_P=0$	4 PLACES ± --- ± --- 3 PLACES ± --- ± --- 2 PLACES ± 0.20 ± --- 1 PLACE ± --- ± --- 0 PLACE ± --- ± ---	mm	INCH	DRAWN BY GMENARLY	DATE 2012/10/11	TITLE SALES DRAWING SAS RECEPTACLE VERTICAL MOUNT, SMT		
		ANGULAR ± 3 °		CHECKED BY SCHEONG	DATE 2013/01/16	molex DOCUMENT NO. SD-78795-001 SHEET NO. 3 OF 3			
		DRAFT WHERE APPLICABLE MUST REMAIN WITHIN DIMENSIONS		APPROVED BY BOKKOK	DATE 2012/11/16				
4	REV			MATERIAL NO. 78795-0001	THIS DRAWING CONTAINS INFORMATION THAT IS PROPRIETARY TO MOLEX INCORPORATED AND SHOULD NOT BE USED WITHOUT WRITTEN PERMISSION				

9 8 7 6 5 4 3 2 1