

LOC	QTY	REV	DESCRIPTION	DATE	APP'D
G	14		REVISED PER 0720-0230-93	2/28/94	JMP

METPRIO
DIMENSIONS LISTED IN mm [INCHES]

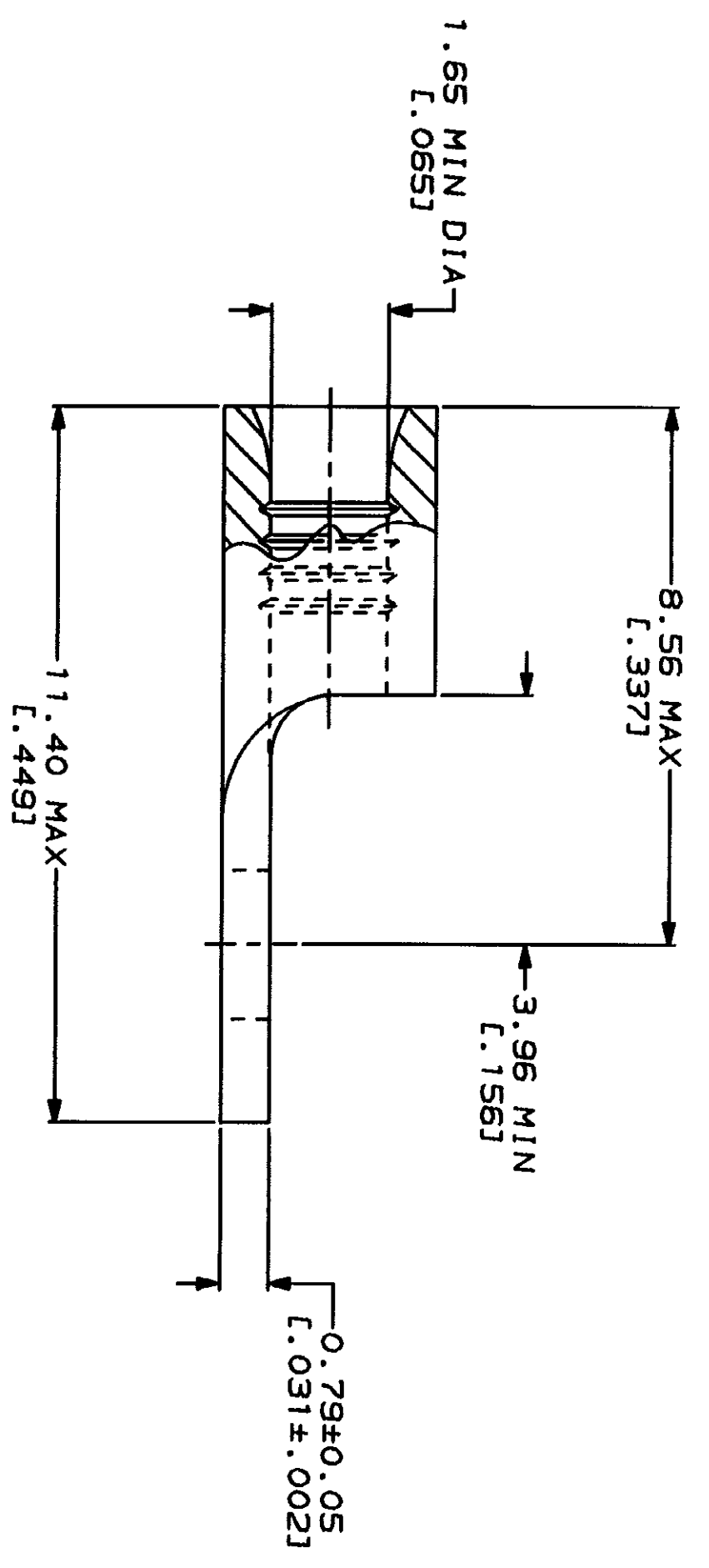
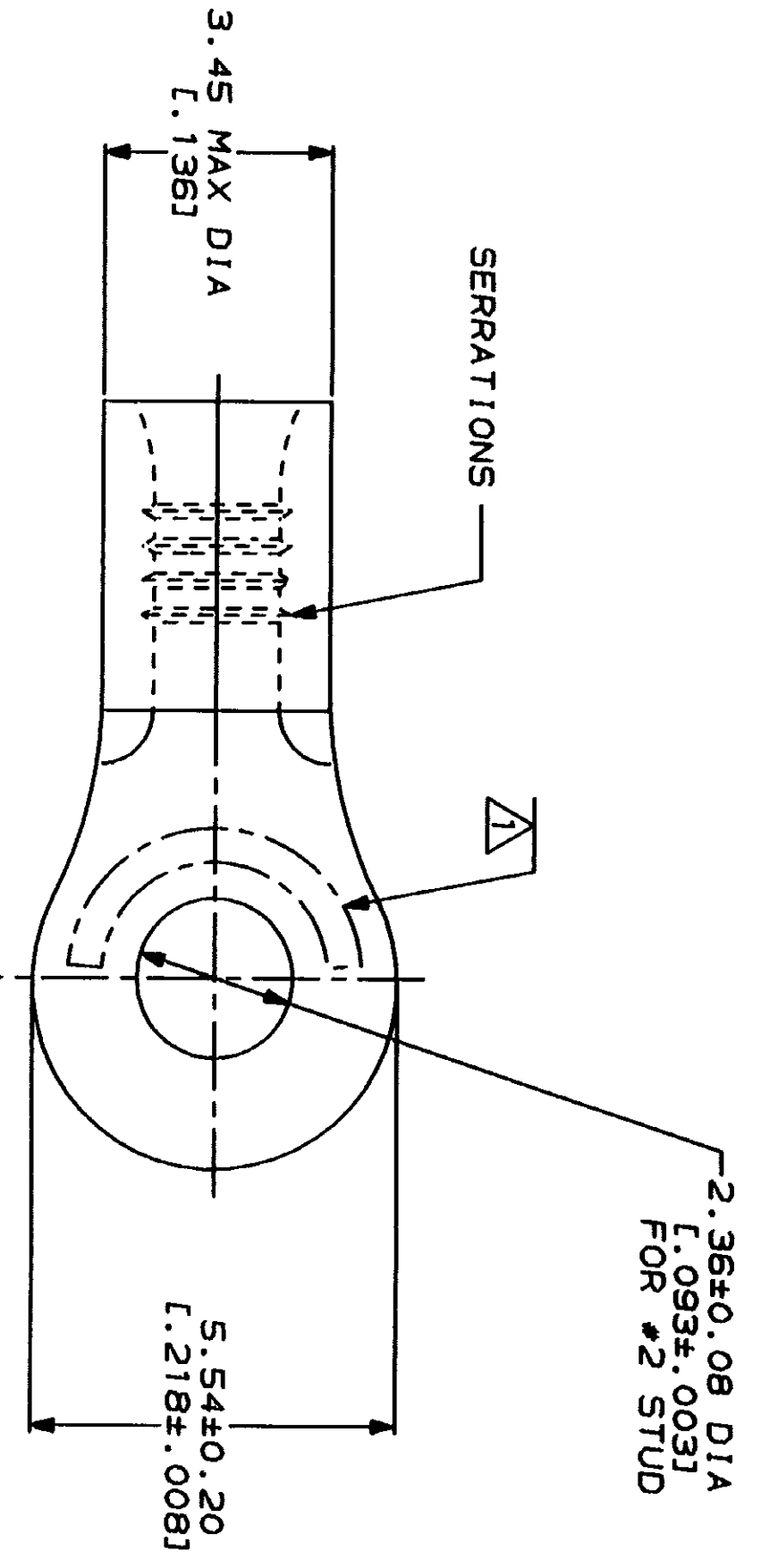

AMP WIRE RANGE 22-16 AWG STRANDED	UL E13288 Listed
• LR7189 Certified	MILITARY P/N AND CLASS
NOT CERTIFIED	NOT APPLICABLE

△ STAMP AMP 22-18* APPROX AS SHOWN
22-16 TERMINALS ARE STAMPED 22-18 IN
ACCORDANCE WITH MILITARY SPECIFICATION
MIL-T-7928, COMMERCIAL WIRE RANGE IS 22-16

AMP INCORPORATED CUSTOMER SERVICE SYSTEMS		MAX RECOMMENDED OPERATING TEMPERATURE: 170°C MAX
FOR ADDITIONAL PRODUCT INFORMATION OR COPIES OF DRAWINGS AND TECHNICAL DOCUMENTS	PRODUCT INFORMATION CENTER 1-800-522-6752	VOLTAGE RATING: NOT APPLICABLE
FOR APPLICATION TOOLING INFORMATION	TOOLING ASSISTANCE CENTER 1-800-722-1111	WIRE CROSS SECTIONAL AREA RANGE: 0.26-1.65mm ² [509-3,260] CIR MILS STRANDED
FOR ORDER ENTRY	1-800-526-5142	THIS DRAWING IS A CONTROLLED DOCUMENT FOR MILITARY AND COMMERCIAL APPLICATIONS. FOR MILITARY APPLICATIONS, THIS DRAWING IS CONTROLLED BY THE MILITARY SERVICE.

DO NOT SCALE PRINT. UNLESS SPECIFIED DIMENSIONS IN - DIMENSIONS - TOLERANCES ON: 2 PLG DEC ± 3 PLG DEC ± ANGLES ± MATERIAL	DR 1-27-83 TA BRINKMAN	AMP AMP Incorporated Harrisburg, PA 17105-3608 TERMINAL, RING TONGUE, BUDGET
FINISH TIN PLATE 0.00254L.0001001 MIN THK PER MIL-T-10727	CHK 1-27-83 DA PATTERSON	
COPPER PER ASTM B-152 ANNEALED	APPD 1-27-83 DE MILLER	
APPLICATION SPEC	APPD 1-27-83 JL HECKLEY	NAME
SCALE 10:1	SCALE 10:1	SIZE CAGE CODE 00779
WEIGHT	WEIGHT	DRAWING NO 31088
		SHEET 1 OF 1

31088
PART NO

CUSTOMER DRAWING