

PART NUMBER	REV	FIRST USED
567944 -1	A	854040-3

TERMINAL NAME: DDC TYPE CONNECTOR (CRIMP DATA PER CUSTOMER SPEC)					
318368	VISIBLE	CRIMPING DATA			
	PAD LTR	CRIMP HEIGHT		WIRE SIZE	
A		.045 ± .002 [1.14 ± 0.05mm]		0.75mm ²	
B		.041 ± .002 [1.04 ± 0.05mm]		0.5mm ²	
C		NOT		USED	
D		NOT		USED	
	CRIMP	SIZE	TYPE	RANGE	
	WIRE	.076 [1.93mm]	F	0.5-0.75mm ²	
	INSUL	.102 [2.59mm]	F	ø2.29mm MAX	
WIRE STRIP LENGTH	TERM APPL SPEC	FEED	APPL INSTRUCTION	SET UP GAGE	LAYOUT
.217 - .236	NONE	.575	SEE CUSTOMER MANUAL	NONE	L1668

SIM TO HDM 680191 AND CQM SCA 567858				70
				69
				68
				67
				66
				65
				64
				63
				62
				61
				60
				59
				58
				57
REF	-	B	694433-8 PAWL, FEED	56
				55
				54
				53
				52
1	-	A	811242-2 BUMPER, HOLDDOWN	51
1	-	A	690753-1 SPACER, TONKER	50
				49
1	-	A	690602-6 CAM, PRE-FEED 1.62 STROKE	48
				47
				46
1	-	A	690191-1 PLUG, NYLON	45
1	-	C	455673-1 RAM	44
1	-	A	690125-1 WASHER, LAMINATED	43
1	-	A	690124-1 WASHER, RAM	42
1	-	A	7-21002-9 BOLT, CRIMPER (5/16x1.00)	41
1	-	A	23241-6 BALL, STEEL	40
1	-	A	690170-1 SPRING, COMPRESSION	39
1	-	C	690142-1 DISC, INSULATION	38
1	-	D	354777-1 WIRE DISC, PLASTIC	37
1	-	A	22480-5 WASHER, SPRING	36
1	-	B	690212-1 POST, RAM	35
1	-	B	690786-1 SUPPORT, TERMINAL	34
1	-	C	462544-1 PLATE, BASE SPECIAL	33
1	-	A	690432-3 SCREW, ADJUSTMENT	32
1	-	B	462543-1 BLOCK, SCREW SPECIAL	31
1	-	B	455689-1 BLOCK, STRIP GUIDE ADJ	30
1	-	C	455671-1 PLATE, STRIP GUIDE	29
1	-	C	455888-4 SPACER, FRONT SHEAR DEP	28
2	-	A	1-22284-0 SPRING, DRAG	27
1	-	B	690546-1 LEVER, DRAG RELEASE	26
1	-	B	240792-1 DRAG, TERMINAL	25
1	-	D	9-690504-2 GUIDE, STRIP (REAR)	24
1	-	A	690438-1 GUIDE, STRIP (FRONT)	23
				22
1	-	A	463756-1 GUIDE, SCRAP	21
1	-	A	904275-1 SUPPORT, SPRING	20
REF	-	C	462615-1 STRIPPER	19
				18
				17
				16
				15
				14
				13
1	-	A	5-22280-0 SPRING, SHEAR	12
1	-	B	1-690461-6 STOP, SHEAR (FRONT)	11
1	-	B	462548-3 HOLDER, SHEAR (FRONT) SP	10
1	-	B	462547-3 SHEAR, FLOAT (FRONT) SP	9
1	-	C	1-662520-6 ANVIL	8
				7
				6
1	-	A	462838-3 DEPRESSOR, SHEAR (FRONT) SP	5
1	-	B	238011-6 SPACER, BLOCK CRIMPER	4
1	-	C	5-683453-5 CRIMPER, INSULATION	3
1	-	C	455888-9 SPACER, CRIMPER	2
1	-	C	3-568176-0 CRIMPER, WIRE	1

2	-	C	5-354779-4	PIN, WIRE DISC (.3260) D	129
2	-	C	4-354779-6	PIN, WIRE DISC (.3220) C	128
					127
					126
1	-	A	986950-1	WASHER, FLAT PRECISION	125
1	-	A	217238-3	GENERAL INSTRUCTION PACKAGE	124
					123
					122
1	-	A	4-21028-0	PIN, SLT SPR (ø.093x.75) ST GDE PL	121
1	-	B	690701-2	PLATE, SERIAL NO.	120
2	-	A	21899-2	WASHER, FLAT (#10) S G ADJ BLK	119
					118
2	-	A	21024-5	WASHER, LOCK (#10) ADJ BLOCK	117
					116
					115
2	-	A	21024-2	WASHER, LOCK (#4) FRONT STP GUIDE	114
REF	-	A	21024-4	WASHER, LOCK (#8) FEED FINGER	113
2	-	A	21024-4	WASHER, LOCK (#8) DEP-HOLD	112
REF	-	A	21024-4	WASHER, LOCK (#8) STRIPPER	111
					110
					109
1	-	A	21018-5	NUT, HEX (#6) HOLD DOWN	108
					107
					106
					105
					104
1	-	A	21009-2	SCR, SKT SET (1/4-20x.25 LW) RAM	103
2	-	A	21017-1	SCR, DRIVE (#2x.12) ID PLATE	102
2	-	A	21017-2	SCR, DRIVE (#2x.19) ID PLATE	101
1	-	B	819347-1	PLATE, IDENTIFICATION	100
2	-	A	3-21002-0	SCR, BHC (10-32x.88) DRAG	99
1	-	A	22733-8	SCR, BHC (8-32x.38 LW) ANVIL	98
					97
1	-	A	3-21000-8	SCR, SHC (10-32x.88) MOUNTING	96
1	-	A	2-21002-7	SCR, BHC (10-32x.50) SG ADJ BLK	95
6	-	A	2-21002-2	SCR, BHC (8-32x.50) SHEAR-TERM SUP	94
					93
					92
1	-	A	1-21002-7	SCR, SHC (6-32x.50) CAM	91
2	-	A	2-21000-7	SCR, SHC (8-32x.50) SCR BLK	90
					89
					88
2	-	A	2-21000-7	SCR, SHC (8-32x.48) DEP-HOLD DOWN	87
REF	-	A	2-22603-0	SCR, HEX HD (8-32x.31) FEED FINGER	86
2	-	A	1-21000-3	SCR, SHC (4-40x.25) F ST GUIDE	85
REF	-	A	22733-9	SCR, BHC (8-32x.50 SL) STRIPPER	84
					83
					82
1	-	A	3-22603-1	SCR, HEX (10-32x.38) SG ADJ BL	81
					80
					79
					78
2	-	B	463310-5	BLADE, STRIPPING (#20)	77
					76
					75
1	-	A	690603-1	SPRING, ASSIST	74
1	-	A	23030-1	SCR, SKT CAP (6-32x.25) CP DSC	73
					72
					71

-1	U/M	DWG SIZE	PART NO	DESCRIPTION	ITEM NO
QTY REQD PER ASSY					
PARTS LIST					
REVISION OF EACH ASSY NO (WHEN BLANK, USE DWG REVISION)					
QTY REQD PER ASSY					
PARTS LIST					
DIMENSIONS IN INCHES. DO NOT SCALE PRINT. TOLERANCES UNLESS OTHERWISE SPECIFIED.			MACH REF STRIPPER CRIMPER		
2 PLC DEC ±			NAME		
3 PLC DEC ±			STRIPPER CRIMPER APPLICATOR		
4 PLC DEC ±			SCALE		
ANGLES ±			DWG NO		
SURF TEXTURE: REMOVE BURRS, BREAK SHARP EDGES R.015 MAX			567944		
A REVISED			1 OF 1		
P/F LTR REVISION RECORD			REV A		

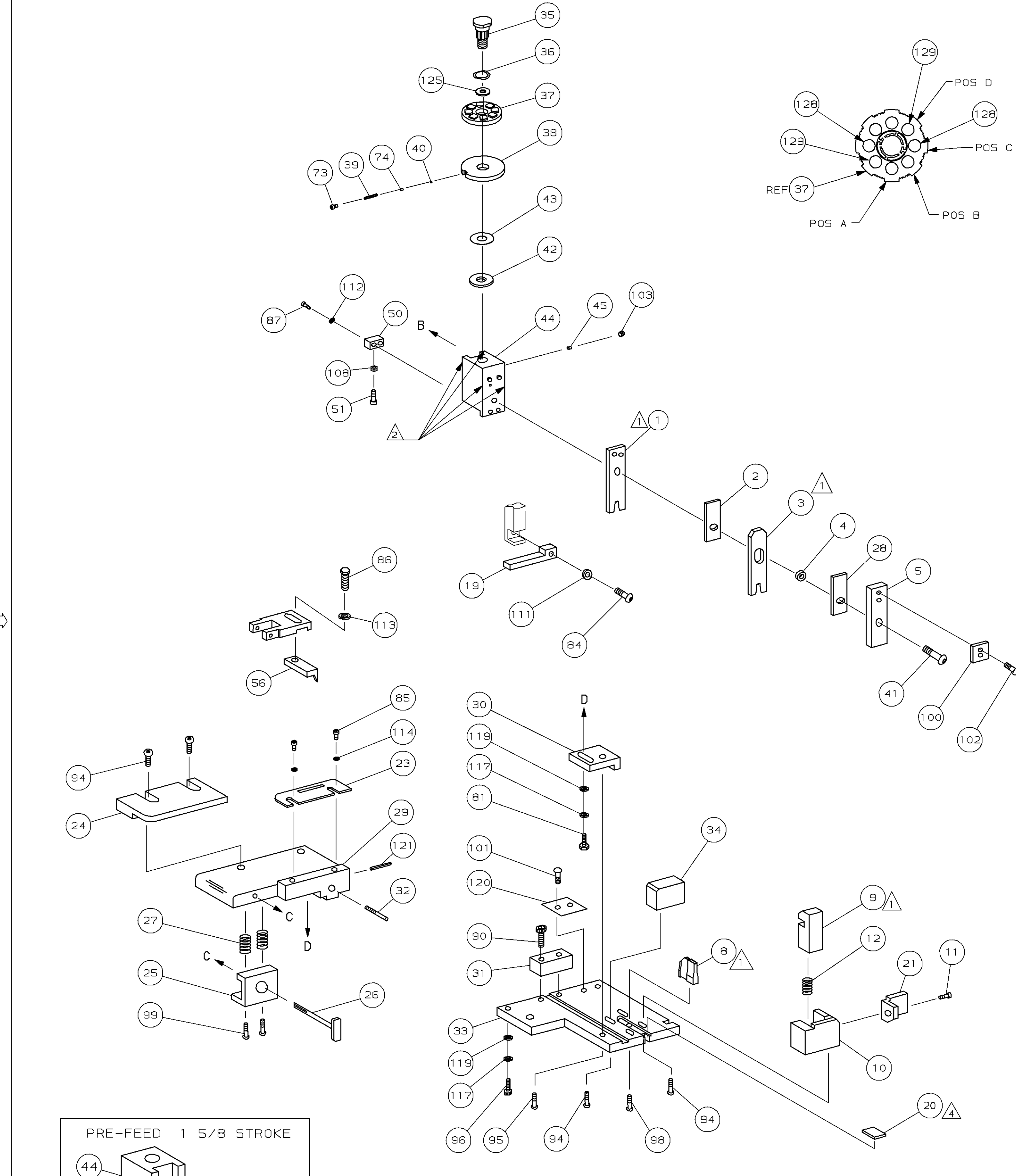

1 RECOMMENDED SPARE PARTS.
 2 GREASE LIGHTLY.
 3 ITEM NOT SHOWN
 4 ATTACH ITEM 20 TO ITEM 33 USING ADHESIVE PART NUMBER 28998-6.
 5 CUT TO LENGTH AT ASSY

LOC A
 DIST 66

PRE-FEED 1 5/8 STROKE
 ROTATED 180°

AMP 3308 REV 3-92 04-DEC-97 14:45:54 amp18246 7

THIS DRAWING IS A CONTROLLED DOCUMENT FOR AMP INCORPORATED. IT IS SUBJECT TO CHANGE AND THE CONTROLLING ENGINEERING ORGANIZATION SHOULD BE CONTACTED FOR THE LATEST REVISION.

THIS INFORMATION IS CONFIDENTIAL AND IS DISCLOSED TO YOU ON CONDITION THAT NO FURTHER DISCLOSURE IS MADE BY YOU TO OTHER THAN AMP PERSONNEL WITHOUT WRITTEN AUTHORIZATION FROM AMP INCORPORATED, HARRISBURG, PA.

567944