

PART NUMBER	REV	FIRST USED	POWER UNIT	FEED TYPE	DESCRIPTION
1852356-1	A	122500-1	LEADMAKER	POST FEED	CUTS CARRIER
1852356-2	A	565435-5	BENCH MODEL K	PRE FEED	CUTS CARRIER
1852356-3	A	354500-1	BENCH MODEL G	PRE FEED	CUTS CARRIER
1852356-6	A	122500-1	LEADMAKER	POST FEED	CONTINUOUS CARRIER
7-1852356-7	A	-	-	-	SPARE PARTS



TERMINAL NAME: BUTT SPLICE			
BUTT SPLICE	-	AMP TERMINAL - AMP CRIMP SPECS	
61021-3	-	PAD LTR	CRIMP HEIGHT
-	-	A	.057±.002 [1.45±0.05mm]
-	-	B	-
-	-	C	-
-	-	D	-
-	-	CRIMP	SIZE TYPE RANGE
-	-	WIRE	.080 [2.03mm] F 18 AWG + HEATER WIRE
-	-	INSUL	.120 [3.05mm] O Ø .096 MAX
WIRE STRIP LENGTH	TERM APPL SPEC	FEED	APPLICATOR INSTRUCTIONS
.185 - .200	NONE	.535	408-8040
			SET UP GAGE 458637-1

LOC	DIST	REV	DESCRIPTION	DATE	BY	APPD
A	66		RELEASED	28NOV2006	LG	TE

- RECOMMENDED SPARE PARTS
- GREASE LIGHTLY
- GUARD MUST BE IN PLACE WHEN OPERATING APPLICATOR IN A BENCH MACHINE
- CUT TO LENGTH AT ASSEMBLY.

HEATER WIRE	NUMBER OF STRANDS	DIAMETER
A	7	.0050

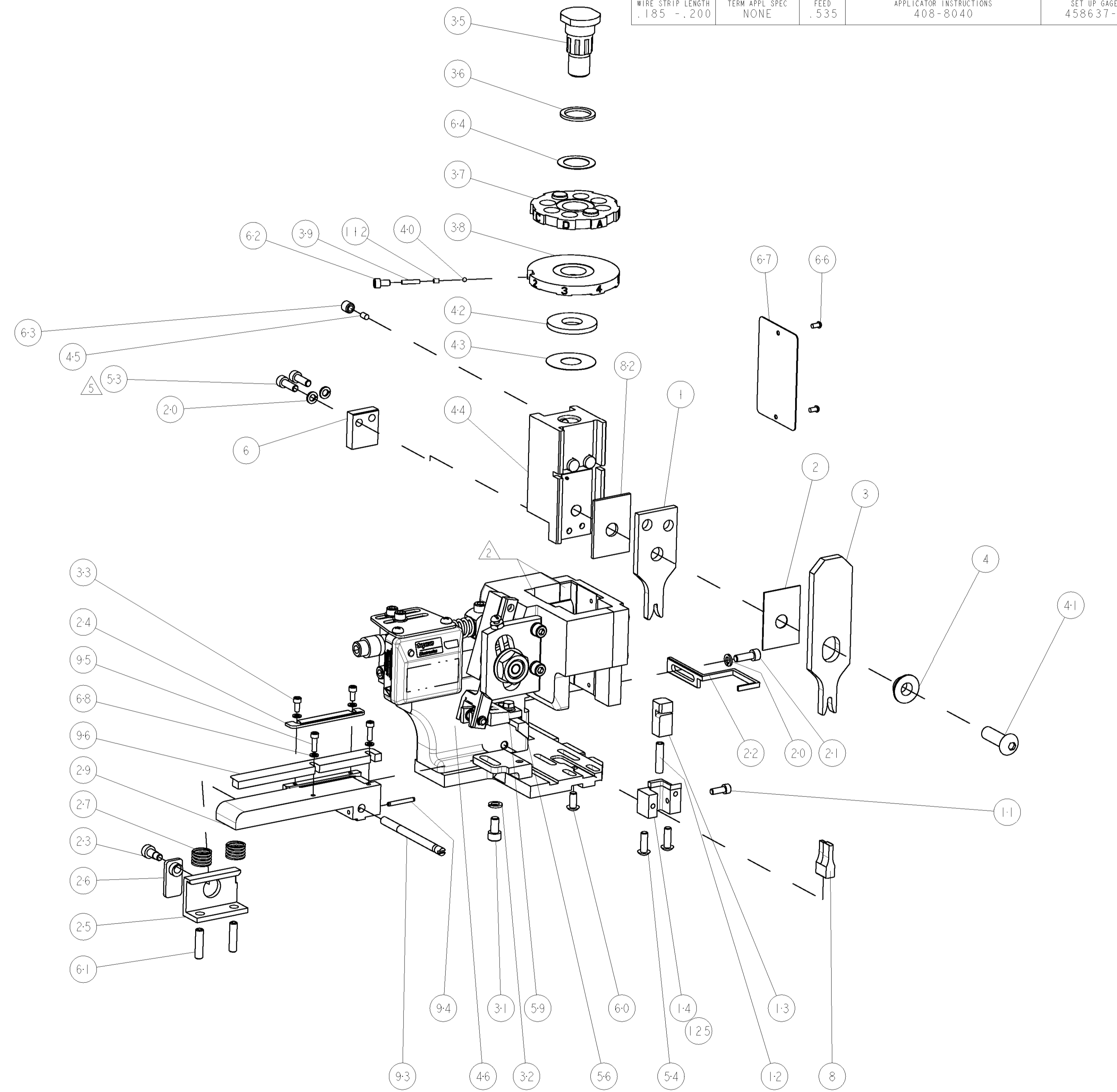
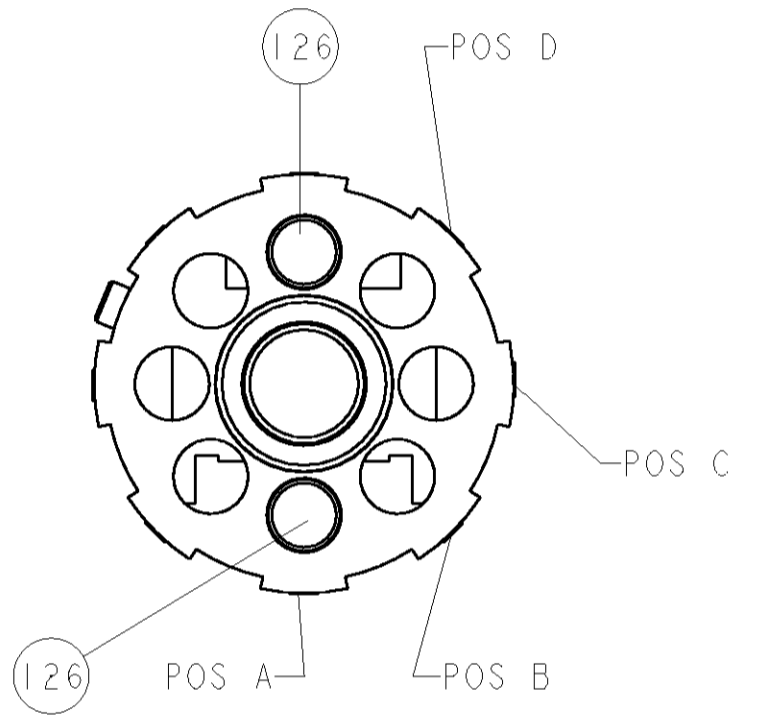

-	2	2	2	2	-	3-354779-0	PIN, WIRE DISC, .3140	126
-	1	-	-	-	-	681023-1	SHEAR HOLDER, REAR	125
-	-	-	REF	-	..	455749-1	GUARD WINDOW	116
-	-	REF	-	-	..	679532-1	INSERT, GUARD	115
-	1	1	1	1	-	690603-1	SPRING ASSIST AMP-O-MATOR APPLICATOR	112
-	1	1	1	1	-	189124-3	GUIDE, FRONT STRIP	96
-	2	2	2	2	-	1-21000-4	SCR, SKT HD CAP 4-40 X .375	95
-	1	1	1	1	-	4-21028-0	PIN, SLOTTED SPRING .094 X .750	94
-	1	1	1	1	-	690432-3	ADJUSTMENT SCREW	93
-	1	1	1	1	-	1-21002-7	SCR, BTN SKT HD CAP 6-32 X .375	91
-	1	1	1	1	-	1-455888-7	SPACER, CRIMPER	82
-	1	1	1	1	-	4088040	SF APPL INST 408-8040	72
-	1	1	1	1	-	217238-1	GENERAL INSTRUCTION PKG	71
-	4	4	4	4	-	21024-2	WASHER, SPRG LOCK, REG NO 4	68
-	1	1	1	1	-	461264-1	PLATE, IDENTIFICATION	67
-	2	2	2	2	-	21017-2	SCREW, DRIVE	66
-	1	1	1	1	-	986950-1	WASHER, FLAT PRECISION	64
-	1	1	1	1	-	21009-2	SCR, SET, SELF LOCKING 1/4-20 X .250	63
-	1	1	1	1	-	23030-1	SCR, SKT HD CAP 6-32 X .25	62
-	2	2	2	2	-	5-21006-6	SCR, SET, CUP POINT 10-32 X .750	61
-	1	1	1	1	-	22733-8	SCR, BHSC, SELF-LOCKING, 8-32 X .375	60
-	1	1	1	1	-	2-22603-0	SCREW, MACH, HEX HD, 8-32 X .312	59
-	1	1	1	1	-	4-694433-0	FEED PAWL	56
-	2	2	2	2	-	2-21002-2	SCR, BTN SKT HD CAP 8-32 X .500	54
-	2	2	2	2	-	2-21000-7	SCR, SKT HD CAP 8-32 X .500	53
-	-	-	-	-	..	690602-6	CAM, PRE FEED, 1 5/8	49
-	-	-	-	-	..	690602-5	CAM, PRE FEED, 1 1/8	48
-	1	-	-	-	-	690501-4	CAM, POST FEED, 1 5/8	47
-	1	1	1	1	-	459456-1	APPL. BASIC SUB ASSY (SIDE WISE MOCA)	46
-	1	1	1	1	-	690191-1	PLUG, NYLON	45
-	1	1	1	1	-	819307-6	RAM, SIDE FEED	44
-	1	1	1	1	-	690125-1	SHIM SUB-ASSY	43
-	1	1	1	1	-	690124-1	WASHER, RAM (.115)	42
-	1	1	1	1	-	7-21002-9	SCR, BTN SKT HD CAP 5/16-24 X 1.00	41
-	1	1	1	1	-	23241-6	BALL, STEEL	40
-	1	1	1	1	-	690170-1	SPRING, COMPRESSION	39
-	1	1	1	1	-	690142-1	DISC, INSULATION	38
-	1	1	1	1	-	354777-1	WIRE DISC, ASSEMBLY	37
-	1	1	1	1	-	22480-5	SPRING, COMPRESSION	36
-	1	1	1	1	-	690212-1	POST, RAM	35
-	2	2	2	2	-	1-21000-3	SCR, SKT HD CAP 4-40 X .250	33
-	1	1	1	1	-	21024-5	WASHER, SPRG LOCK, REG NO 10	32
-	1	1	1	1	-	3-21000-4	SCR, SKT HD CAP 10-32 X .375	31
-	1	1	1	1	-	844048-4	PLATE, REAR STRIP GUIDE	29
-	2	2	2	2	-	1-22284-0	SPRING, COMPRESSION	27
-	1	1	1	1	-	356835-1	LEVER, DRAG RELEASE	26
-	1	1	1	1	-	240792-1	DRAG, TERMINAL	25
-	1	1	1	1	-	690438-1	FRONT STRIP GUIDE	24
-	1	1	1	1	-	21989-8	SCR, SKT HD SHLDR 3/16 DIA X .250	23
-	1	1	1	1	-	458230-4	STRIPPER	22
-	1	1	1	1	-	2-21000-7	SCR, SKT HD CAP 8-32 X .500	21
-	4	4	4	4	-	21024-4	WASHER, SPRG LOCK, REG NO 8	20
-	-	-	-	-	..	690462-1	SHEAR HOLDER, REAR	14
-	1	1	1	1	-	1-690463-8	FLOATING SHEAR, REAR	13
-	1	1	1	1	-	6-22279-2	SPRING, COMPRESSION	12
-	1	1	1	1	-	1-21000-9	SCR, SKT HD CAP 6-32 X .375	11
-	1	1	1	1	-	1633509-1	ANVIL, REAR CARRIER	8
-	1	1	1	1	-	690468-2	DEPRESSOR SHEAR, REAR	6
-	1	1	1	1	-	238009-5	BLOCK, FL CRIMPER SPACER	4
-	1	1	1	1	-	8-1583690-5	CRIMPER, INSUL O	3
-	1	1	1	1	-	455888-5	SPACER, CRIMPER	2
-	1	1	1	1	-	7-1633305-3	CRIMPER, WIRE PREMIUM	1

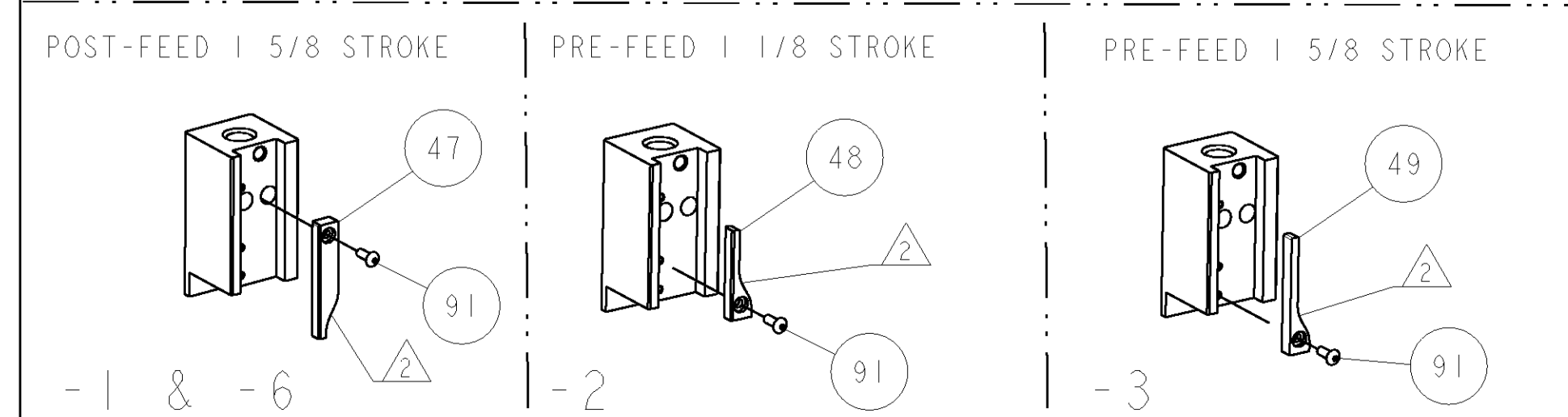

INCHES	TOLERANCES UNLESS OTHERWISE SPECIFIED:	FINISH	WEIGHT	CUSTOMER DRAWING
0 PLC	±			
1 PLC	±0.1			
2 PLC	±0.01			
3 PLC	±0.001			
4 PLC	±0.0001			
ANGLES	±0.0001			