

Cable housing - KGS-MSTB 2,5/20 - 1805615

Please be informed that the data shown in this PDF Document is generated from our Online Catalog. Please find the complete data in the user's documentation. Our General Terms of Use for Downloads are valid (<http://download.phoenixcontact.com>)



Cable housing, Pitch: 5 mm, Number of positions: 20, Dimension a: 100 mm, Color: green

The illustration shows an 8-position version



Key commercial data

Packing unit	1
Minimum order quantity	10
Catalog page	Page 194 (CC-2005)
GTIN	 4 017918 046620
Custom tariff number	85472000
Country of origin	POLAND

Technical data

Dimensions / positions

Pitch	0 mm
Dimension a	100 mm
Number of positions	20

Technical data

Range of articles	KGS-MSTB 2,5
Insulating material group	I
Insulating material	ABS
Inflammability class according to UL 94	HB

Classifications

ETIM

ETIM 3.0	EC001121
ETIM 4.0	EC000879
ETIM 5.0	EC000879

Cable housing - KGS-MSTB 2,5/20 - 1805615

Classifications

UNSPSC

UNSPSC 11	39121409
UNSPSC 12.01	39121409
UNSPSC 13.2	39121409
UNSPSC 6.01	30211810
UNSPSC 7.0901	39121409

eCl@ss

eCl@ss 4.0	272607xx
eCl@ss 4.1	27260701
eCl@ss 5.0	27260701
eCl@ss 5.1	27260701
eCl@ss 6.0	27260704
eCl@ss 7.0	27440402

Accessories

Accessories

Cable/conductor

Accessories - KD-KGS-MSTB - 1804658



Molded cable strain relief, suitable for KGS-... cable housings, prevents the cable from being bent

Marking

Cable housing - KGS-MSTB 2,5/ DST - 1784914

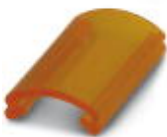

Transparent label carrier, can be marked with marker strips SBS 2.5/7.5

Marking card for terminal marking - SBS 2,5/7,5 - 1007604



Marking card for terminal marking, Card, white, Unlabeled, Can be labeled with: Plotter, Perforated, Mounting type: Snap into tall marker groove, Snap into flat marker groove, For terminal block width: 2.5 mm, Lettering field: 15 x 7.5 mm

Cable housing - KGS-MSTB 2,5/20 - 1805615

Drawings

Dimensioned drawing

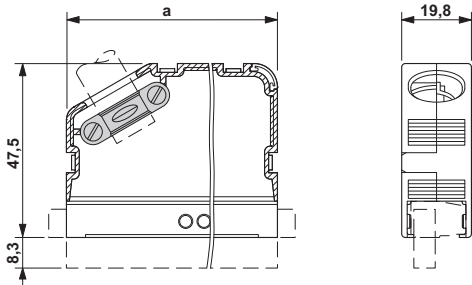

© Phoenix Contact 2012 - all rights reserved
<http://www.phoenixcontact.com>