

SEE NOTE 3

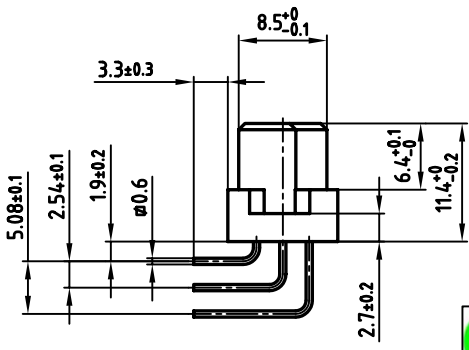
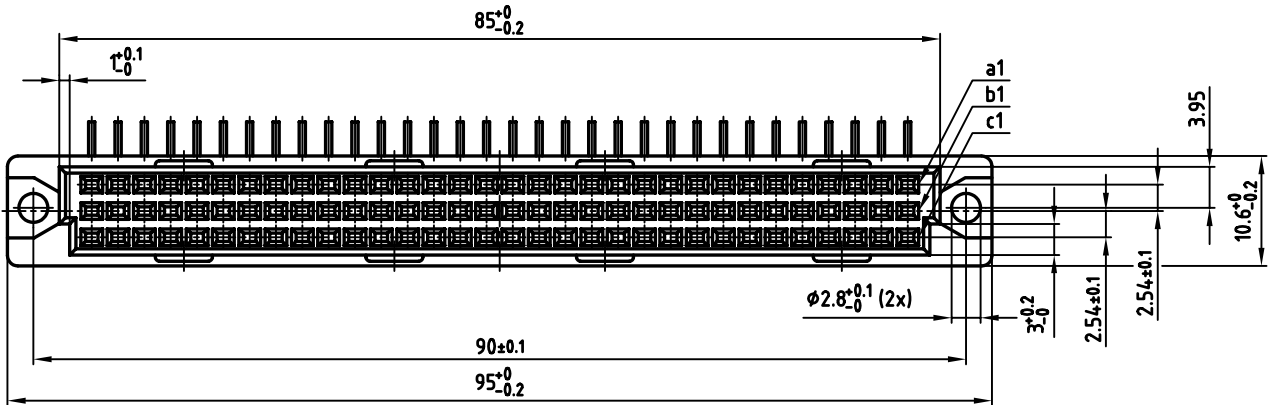
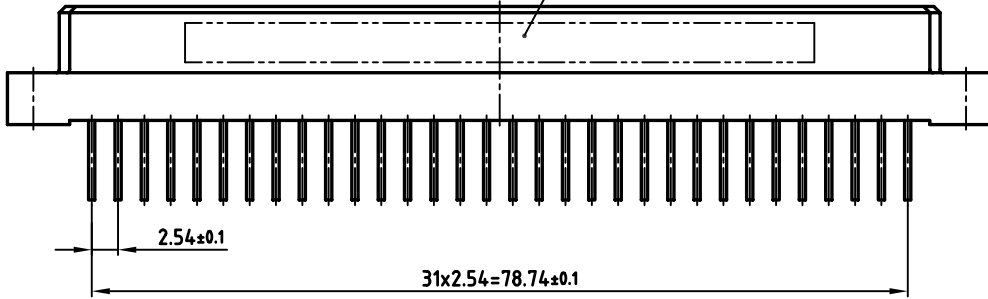

Directive 2002/95/EC
„RoHS“
Compliant

NOTES:

- INSULATORS: PBTP GF UL 94 V-0, GREY
- CONTACTS: COPPER ALLOY
PLATING: GOLD OVER NICKEL
50 MATING CYCLES
- CONNECTOR IS PART MARKED: 122A10409X CONEC ABC

P.C.B. HOLE-DRILLINGS

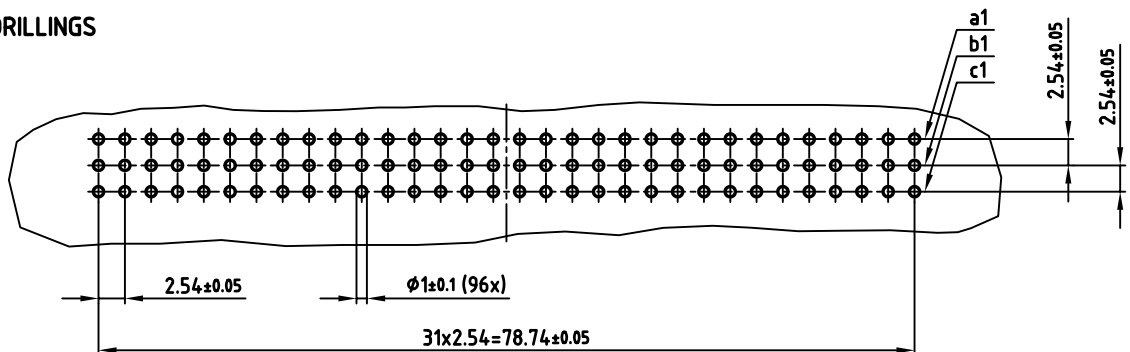

APPROVAL # FREIGABE # DEBLOCAGE # AUTORIZACION # APPROVAL

CUSTOMER APPROVAL DATE:

NAME: TITLE:

COMPANY NAME:

APPROVAL # FREIGABE # DEBLOCAGE # AUTORIZACION # APPROVAL

THIS DRAWING MAY NOT BE COPIED OR REPRODUCED IN ANY WAY, AND MAY NOT BE PASSED ON TO A THIRD PARTY, WITHOUT WRITTEN PERMISSION. OWNERSHIP AND COPYRIGHT OF CONEC GMBH DO NOT ALTER CAD DRAWING BY HAND

rev.	description	date	name

tolerance:

scale: 2:1

material: SEE NOTES

title: FEMALE CONNECTOR TYPE "C"
96pos. ANGLED

dwg no: AutoCAD 2004 DIN-A 3 sh: 1/1

12K1A361

part no: 122A10409X

