

## Nut - A-INL-M25-P-LG - 1417661

Please be informed that the data shown in this PDF Document is generated from our Online Catalog. Please find the complete data in the user's documentation. Our General Terms of Use for Downloads are valid (<http://phoenixcontact.com/download>)

Nut, Cable gland material: Polyamide, PA 6 GF 30, for threads M25, Color: lightgrey RAL 7035



### Key Commercial Data

Packing unit	1 STK
Minimum order quantity	5 STK
Custom tariff number	39269097
Country of origin	Turkey

### Technical data

#### Dimensions

Length	6 mm
Connecting thread diameter	25 mm
Wrench size, counter nut	32 mm
Hexagon angular dimension	35 mm

#### Ambient conditions

Ambient temperature (operation)	-20 °C ... 100 °C
---------------------------------	-------------------

#### General

Material	PA 6 GF 30
Cable gland material	Polyamide
Color	lightgrey RAL 7035

### Drawings

## Nut - A-INL-M25-P-LG - 1417661

Dimensional drawing

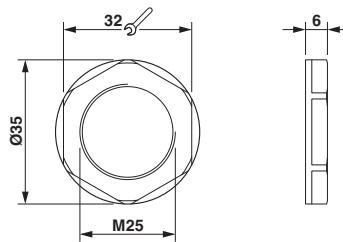

### Classifications

eCl@ss

eCl@ss 5.1	23110701
eCl@ss 8.0	23110701

ETIM

ETIM 5.0	EC000129
----------	----------