

THIS INFORMATION IS CONFIDENTIAL AND IS DELIVERED TO YOU ON CONDITION THAT
 YOU WILL NOT DISCLOSE IT TO ANY OTHER PERSON OR ORGANIZATION WITHOUT
 THE WRITTEN PERMISSION OF THE APPLICATOR. THE APPLICATOR'S NAME AND ADDRESS
 SHOULD BE CONTACTED FOR THE LATEST REVISION.

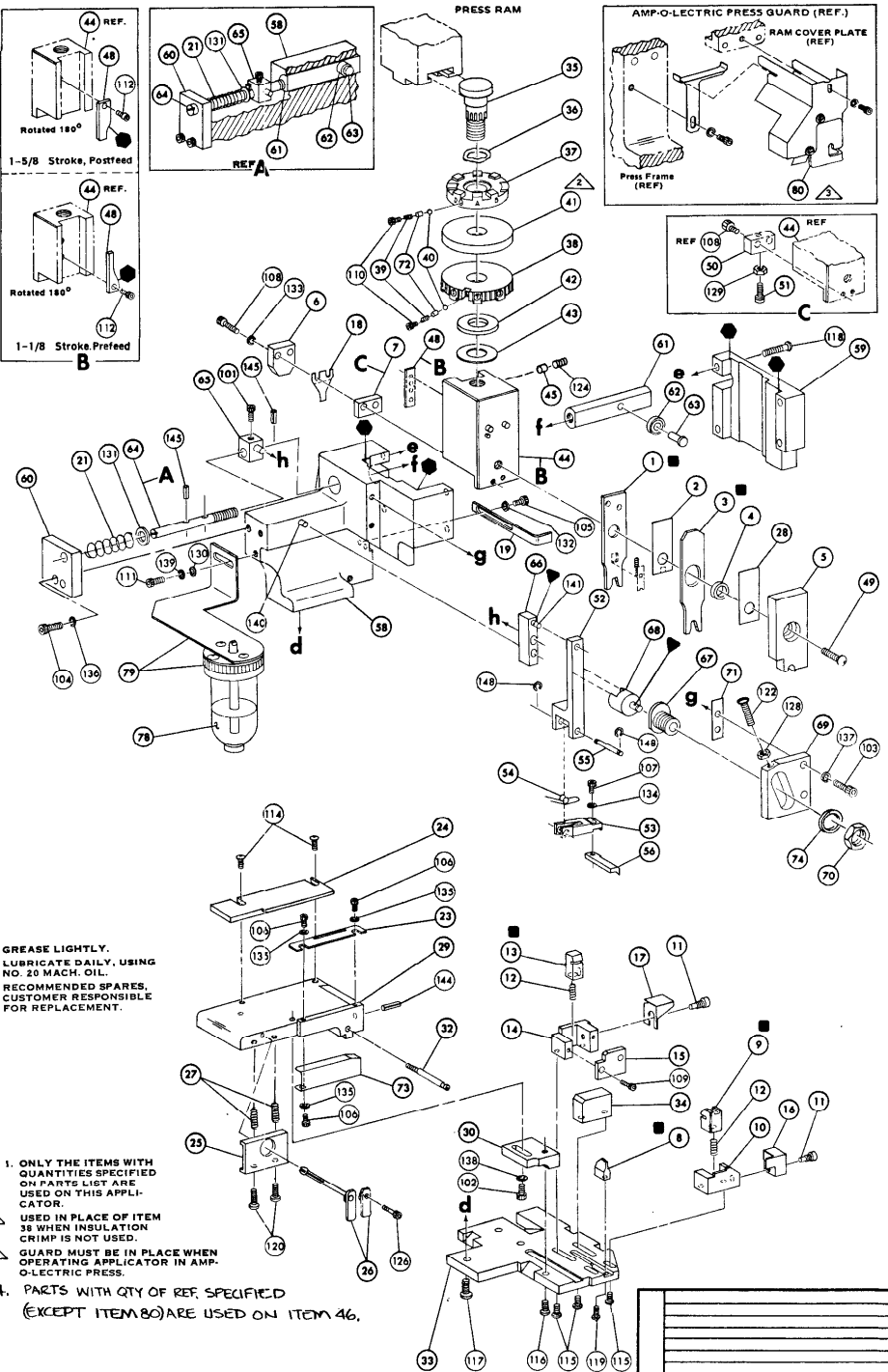

KEY:

- GREASE LIGHTLY. LUBRICATE DAILY, USING NO. 20 MACH. OIL.
- RECOMMENDED SPARES, CUSTOMER RESPONSIBLE FOR REPLACEMENT.

- NOTES:**
- ONLY THE ITEMS WITH QUANTITIES SPECIFIED ON PARTS LIST ARE USED ON THIS APPLICATOR.
 - USED IN PLACE OF ITEM 38 WHEN INSULATION CRIMP IS NOT USED.
 - GUARD MUST BE IN PLACE WHEN OPERATING APPLICATOR IN AMP-O-LECTRIC PRESS.
 - PARTS WITH QTY OF REF. SPECIFIED (EXCEPT ITEM 80) ARE USED ON ITEM 46.

162	REF	690517-1	SPACER	71
161		22594-8	NUT, HEX	70
160		24062-1	PLATE, ADJUSTMENT	69
159		240626-1	SHAFT, PIVOT	68
158		240633-1	BUSHING	67
157		455680-1	LEVER, INTERMEDIATE	66
156		240629-1	BLOCK, PIVOT	65
155		240632-2	SCREW, ADJUSTMENT, FEED ROD	64
154		240659-3	PIN, CAM ROLLER	63
153		240658-1	ROLLER, CAM	62
152		454398-2	ROD, FEED	61
151		454178-1	GUIDE, FEED ROD	60
149		454220-1	CAP, HOUSING	59
148		454485-1	HOUSING	58
REF		21045-3	RING, RETNG "C" (.187 DIA) FEED FINGER PIN	57
147		690542-2	PAWL, FEED	56
146	REF	240624-1	PIN, FEED FINGER	55
145	REF	691499-1	SPRING, FEED FINGER	54
144	REF	690541-1	FINGER, FEED	53
143	REF	455679-1	LEVER, TERMINAL FEED ARM	52
142	REF	611242-2	BUMPER, HOLDDOWN	51
141	REF	690753-1	SPACER, TONKER	50
140	REF	712002-9	BOLT, CRIMPER	49
139	REF	690501-4	CAM POSTFEED 5/8STROKE	48
138				47
137	REF	459456-1	APPL, BASIC SUB ASSY	46
136	REF	690191-1	PLUG, NYLON	45
135	REF	455673-1	RAM	44
134	REF	690125-1	WASHER, LAMINATED	43
133	REF	690124-1	WASHER, RAM	42
132	REF	23241-6	DISC, SPACER	41
131	REF	21899-4	WASHER, FLAT (5/16 DIA) SCREW ADJ	40
130	REF	21899-2	WASHER, FLAT (NO. 10) LUB ASSY	39
129	REF	21068-5	NUT, HEX MACH (6-32) HOLDDOWN	38
128	REF	21068-5	NUT, HEX MACH (6-32) FEED ADJ	37
127	REF	22480-5	WASHER, SPRING	36
126	REF	690212-1	POST, RAM	35
125	REF	455676-1	SUPPORT, TERMINAL	34
124	REF	690432-3	PLATE, BASE	33
123	REF	690432-3	SCREW, ADJUSTMENT	32
122	REF	21064-2	SCREW, RD HD MACH (6-32 x 1.50) FEED ADJ	31
121	REF	455689-1	BLOCK, STRIP GUIDE ADJ	30
120	REF	455611-1	PLATE, STRIP GUIDE	29
119	REF	1-455688-0	SPACER, F. SHEAR DEPRESSOR	28
118	REF	1-27284-0	SPRING, DRAG	27
117	REF	1-24073-9	SCREW, BTN HD SKT CAP (NYLOK) 1/4-20 x .75 HSG	26
116	REF	21002-7	SCREW, BTN HD SKT CAP (10-32 x .50) S.G. ADJ BLK	25
115	REF	21002-2	SCREW, BTN HD SKT CAP (8-32 x .50) SHEAR	24
114	REF	21002-2	SCREW, BTN HD SKT CAP (8-32 x .50) R. S. G.	23
113	REF	21003-0	SCREW, FLAT HD SKT CAP (6-32 x .50) CAM	22
112	REF	21004-4	SCREW, SKT HD CAP (10-32 x .38) LUB ASSY	21
111	REF	23030-1	SCREW, SKT HD CAP (6-32 x .25) (NYLOK) C.P. DISC	20
110	REF	21000-8	SCREW, SKT HD CAP (6-32 x .31) R. SHEAR PLATE	19
109	REF	21000-8	SCREW, SKT HD CAP (8-32 x .62) DEPRESSOR	18
108	REF	21000-3	SCREW, SKT HD CAP (4-40 x .25) F. STRIP GUIDE	17
107	REF	21000-7	SCREW, SKT HD CAP (8-32 x .50) STRIPPER	16
106	REF	21000-4	SCREW, SKT HD CAP (10-32 x .62) FEED ADJ BLK	15
105	REF	21000-6	SCREW, SKT HD CAP (10-32 x .38) S.G. ADJ BLK	14
104	REF	21000-4	SCREW, SKT HD CAP (10-32 x .38) S.G. ADJ BLK	13
103	REF	21000-4	SCREW, SKT HD CAP (10-32 x .38) S.G. ADJ BLK	12
102	REF	21000-4	SCREW, SKT HD CAP (10-32 x .38) S.G. ADJ BLK	11
101	REF	21000-4	SCREW, SKT HD CAP (10-32 x .38) S.G. ADJ BLK	10
100	REF	455149-1	GUARD ASSY (WINDOW)	9
99	REF	1465184-0	LUBRICATOR ASSY	8
98	REF	1465184-0	LUBRICATOR ASSY	7
97	REF	240641-5	SPACER, DEPRESSOR REAR	6
96	REF	240641-5	DEPRESSOR, SHEAR REAR	5
95	REF	240641-5	DEPRESSOR, SHEAR FRONT	4
94	REF	240641-5	SPACER, TUBULAR, INS CRIMPER	3
93	REF	240641-5	CRIMPER, INSULATION	2
92	REF	240641-5	SPACER, CRIMPER	1
91	REF	240641-5	CRIMPER, WIRE	1

APPLICATION SPECIFICATION: 114-10007

CRIMPING DATA				THIS APPLICATOR WILL APPLY	
PAC LETTER	CRIMP HEIGHT	WIRE SIZE	WIRE STRIP LENGTH		
A	.068	# 14		SOC	PIN
B	.059	# 16		66578	66577
C	.052	# 18		66651	66650
D	NOT USED				

CRIMP	SIZE	TYPE	FEED	USED ON
WIRE	.030	F	.500	MACH NO.
INSULATION	140	O		

INSULATION RANGE: 105-135 WIRE RANGE: 18-14 APPLICATOR INSTRUCTION: #3040

REMARKS: AMPOMATOR

I.D. PLATE (REF): 461264-1

DATE: 10-29-73 DRAWN: RANOFFS APPROVED: Ken. Hogue

SCALE: NONE NAME: ILMILLER

LOC: C No. 687997-3

APPLICATOR MINIATURE QUICK CHANGE SIDE-FEED (TYPE II .062 DIA. PIN & SOC.)

THIS INFORMATION IS CONFIDENTIAL AND IS DELIVERED TO YOU ON CONDITION THAT
 YOU WILL NOT DISCLOSE IT TO ANY OTHER PERSON OR ORGANIZATION WITHOUT
 THE WRITTEN PERMISSION OF THE APPLICATOR. THE APPLICATOR'S NAME AND ADDRESS
 SHOULD BE CONTACTED FOR THE LATEST REVISION.

LTN	REVISION RECORD	ECN	DATE	LTN	REVISION RECORD	ECN	DATE
F1	ECR 15-010/64						
F	0150-6987-96						
E	ECN 210052 B						
D3	REV PER ECN						
D1	ADD TUBING 461264-1						
D	REV PER ECN						
C	ADD TUBING 461264-1						
B	REV PER ECN						
A	ADD TUBING 461264-1						

114-10007-3