

used for: DIN EN 60603 TYPE "C"

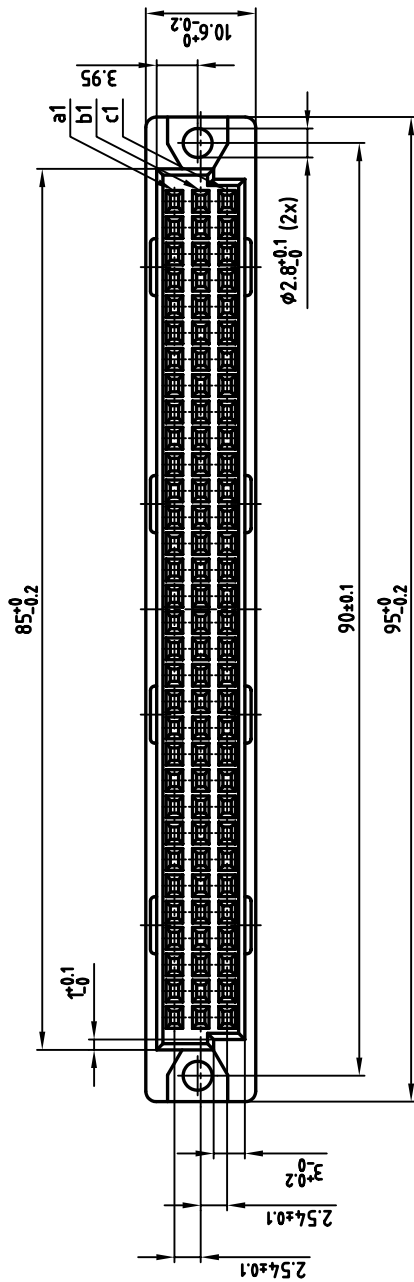

**NOTES:**

1. INSULATORS: PBT GF UL 94 V-0, GREY
2. CONTACTS: COPPER ALLOY  
PLATING: GOLD OVER NICKEL  
50 MATING CYCLES
3. CONNECTOR IS PART MARKED: 122A10299X CONEC ABC

SEE NOTE 3

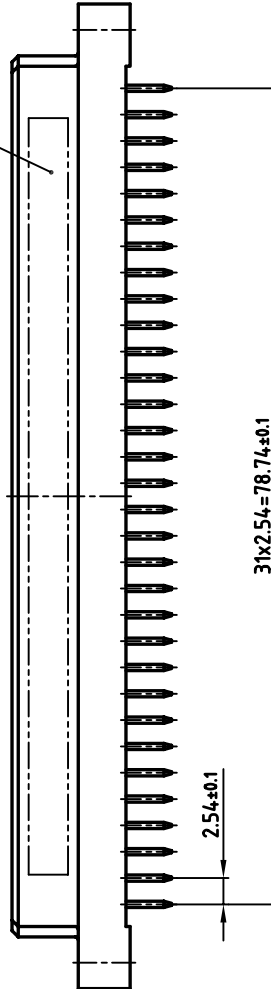
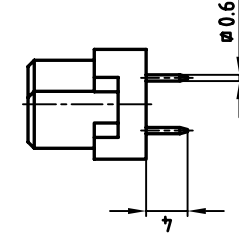

APPROVAL # FREIGABE # DEBLOCKAGE # AUTORIZACION # APPROVAL	
CUSTOMER APPROVAL DATE:	
NAME:	TITLE:
COMPANY NAME:	
APPROVAL # FREIGABE # DEBLOCKAGE # AUTORIZACION # APPROVAL	

THIS DRAWING MAY NOT BE COPIED OR REPRODUCED IN ANY WAY, AND MAY NOT BE PASSED ON TO A THIRD PARTY WITHOUT WRITTEN PERMISSION.  
OWNERSHIP AND COPYRIGHT OF CONEC GMBH DO NOT ALTER CAD DRAWING BY HAND

rev.	description	date	name
1 x b	A 2335	19.07.2006	Lehmen
a	Origin		

2003	date	26.03.	Schmidt
	drawn	26.03.	Kühle
	appd.		
	norm	DIN EN 60603	
	d-old		

tolerance dim. in mm  
scale: 2:1  
material: SEE NOTES  
title: (b) FEMALE CONNECTOR TYPE "C"  
64 pos. SOLDER PIN

dwg no: 12K1A246  
DIN-A  
3  
sh:1/2  
part no: 122A10299X



