

PART NUMBER	REV	FIRST USED
567814-1	C	854040-4

TERMINAL NAME:	
PIN	SOCKET
350416	350415
TERM APPL SPEC 114-49000	

VISIBLE PAD LTR	CRIMPING DATA		
	CRIMP HEIGHT	WIRE SIZE	
A	.048 ±.002	18 OR (2) 20	
B	.043 ±.002	20	
C	NOT	USED	
D	.055 ±.002	16	
CRIMP	SIZE	TYPE	RANGE
WIRE	.090	F	20-16 <sup>4</sup>
INSUL	.140	F	.130 MAX
FEED	APPL INST	SET UP GAGE	LAYOUT
.490	A1	-	603
WIRE STRIP LENGTH .156-.186			

STANDARD FORCE CRIMP QUALITY MONITOR APPLICATOR  
SIM TO SC 466959-1

					70
					69
					68
					67
					66
					65
					64
					63
					62
					61
					60
					59
					58
					57
					56
					55
					54
					53
					52
					51
					50
					49
					48
					47
					46
					45
					44
					43
					42
					41
					40
					39
					38
					37
					36
					35
					34
					33
					32
					31
					30
					29
					28
					27
					26
					25
					24
					23
					22
					21
					20
					19
					18
					17
					16
					15
					14
					13
					12
					11
					10
					9
					8
					7
					6
					5
					4
					3
					2
					1

					125
					124
					123
					122
					121
					120
					119
					118
					117
					116
					115
					114
					113
					112
					111
					110
					109
					108
					107
					106
					105
					104
					103
					102
					101
					100
					99
					98
					97
					96
					95
					94
					93
					92
					91
					90
					89
					88
					87
					86
					85
					84
					83
					82
					81
					80
					79
					78
					77
					76
					75
					74
					73
					72
					71

QTY REQD PER ASSY	U/M	DWG SIZE	PART NO	DESCRIPTION	ITEM NO
REVISION OF EACH ASSY NO (WHEN BLANK, USE DWG REVISION)					
PARTS LIST					

QTY REQD PER ASSY	U/M	DWG SIZE	PART NO	DESCRIPTION	ITEM NO
REVISION OF EACH ASSY NO (WHEN BLANK, USE DWG REVISION)					
PARTS LIST					

THIS DRAWING IS A CONTROLLED DOCUMENT.

10-1-1995

RELEASED FOR PUBLICATION BY AMP INCORPORATED. ALL RIGHTS RESERVED. COPYRIGHT 1998

LOC A DIST 66

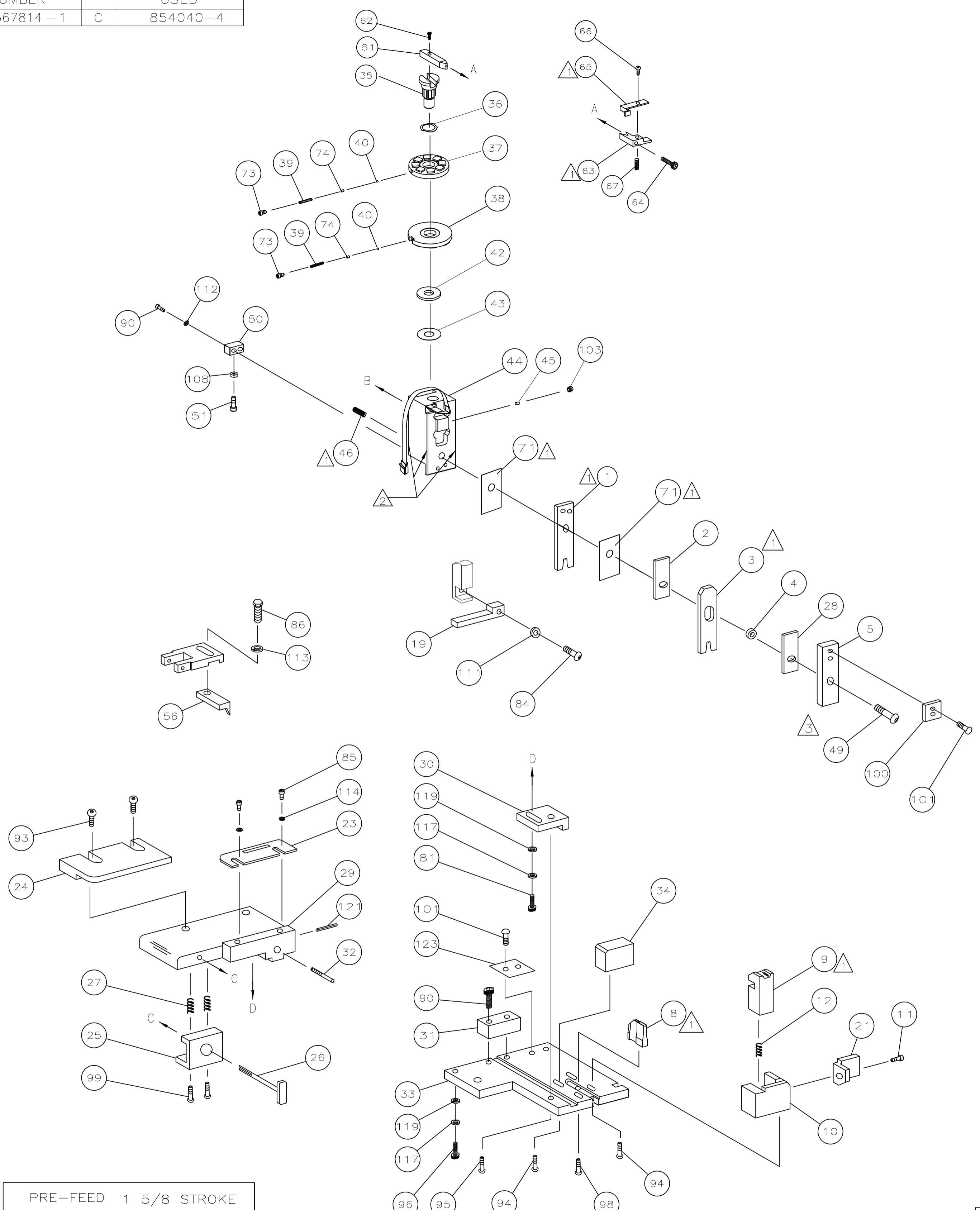

- <sup>1</sup> RECOMMENDED SPARE PARTS.
- <sup>2</sup> GREASE LIGHTLY.
- <sup>3</sup> TORQUE ITEM 49 TO 60 INCH POUNDS
- <sup>4</sup> 16 AWG NOT RECOMMENDED

DIMENSIONS IN INCHES. DO NOT SCALE PRINT. TOLERANCES UNLESS OTHERWISE SPECIFIED:		MATL	HT TR	FIN
2 PLC DEC ±	3 PLC DEC ±	DR P.MATHIAS	7/30/92	APP 10/1/98
4 PLC DEC ±	ANGLES ±	CHK 10/1/98	REL 10/1/98	C.ERISMAN
SURF TEXTURE: <input checked="" type="checkbox"/>	REMOVE BURRS, BREAK SHARP EDGES R.015 MAX	C.ERISMAN	C.ERISMAN	C.ERISMAN
NAME		CQM STRIPPER CRIMPER APPLICATOR		MACHINE REF
SCALE		DWG NO 567814		STRIPPER CRIMPER
GAGE CODE 00779		CUSTOMER AND ASSEMBLY DRAWING 1		SHEET 1 OF 1
				REV C

567814