

THIS DRAWING IS A CONTROLLED DOCUMENT.

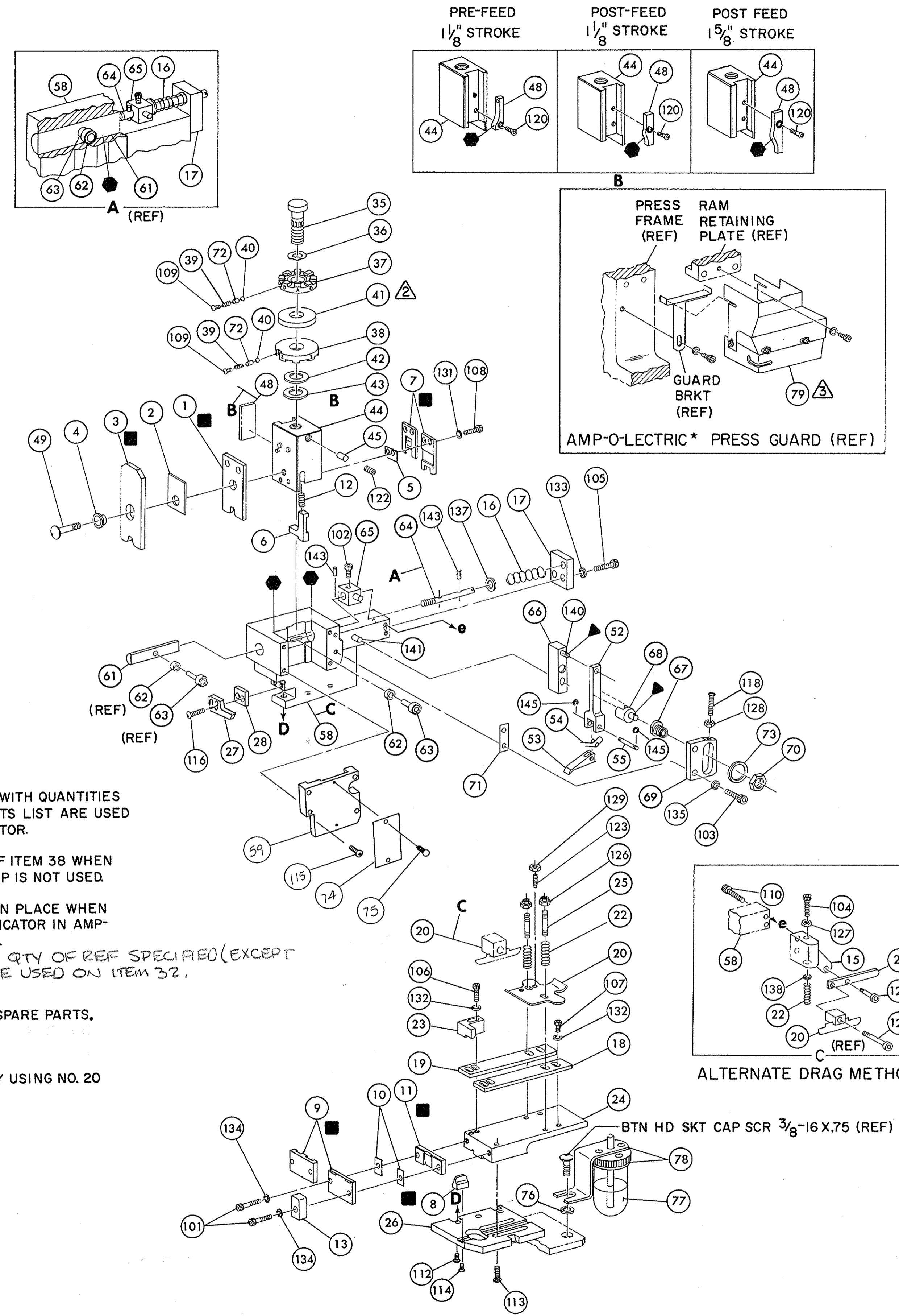

- NOTES:**
- 1. ONLY THE ITEMS WITH QUANTITIES SPECIFIED ON PARTS LIST ARE USED ON THIS APPLICATOR.
 - △ USED IN PLACE OF ITEM 38 WHEN INSULATION CRIMP IS NOT USED.
 - ▲ GUARD MUST BE IN PLACE WHEN OPERATING APPLICATOR IN AMP-O-LECTRIC PRESS.
 - 4. PARTS WITH QTY OF REF SPECIFIED (EXCEPT ITEM 79) ARE USED ON ITEM 32.
- KEY:**
- RECOMMENDED SPARE PARTS.
 - ▲ LUBRICATE DAILY USING NO. 20 MACHINE OIL.
 - GREASE LIGHTLY.

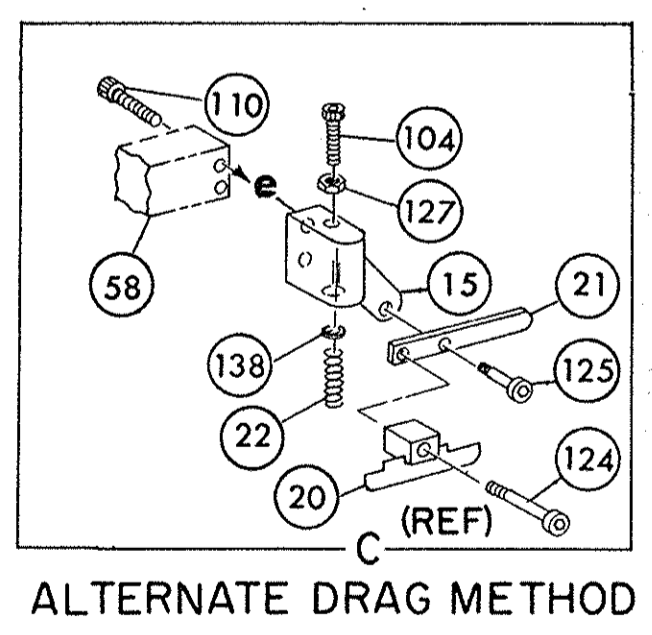

THIS DRAWING IS UNCONTROLLED. ALL RIGHTS RESERVED. © COPYRIGHT 1988 BY AMP INCORPORATED.

DIST 66 * Trademark of AMP Incorporated

QTY	PART NO	DESCRIPTION	ITEM NO	QTY	PART NO	DESCRIPTION	ITEM NO
REF	21045-3	RING, RETAINING 'C' (.187 DIA) FEED PIN	145	REF	454220-1	CAP, RAM	59
REF	5-21028-1	PIN, SLOT SPG (.12 DIA X .50) FD ADJ ROD	143	REF	453736-1	HOUSING	58
REF	1-21030-7	PIN, DOWEL (.187 DIA X 1.50) HOUSING	141	REF	240624-1	PIN, FEED FINGER	55
REF	1-21030-1	PIN, DOWEL (.187 DIA X .50) LEVER	140	REF	691499-1	SPRING, FEED FINGER	54
REF	22260-5	WASHER, FLAT (NO 6) DRAG SPRING	138	REF	240635-1	FINGER, FEED	53
REF	21899-4	WASHER, FLAT (5/16 DIA) SCR ADJ	137	REF	240634-3	LEVER, TERMINAL	52
REF	21024-5	WASHER, LOCK (NO 10) FEED ADJ PLATE	135	1	7-21002-9	BOLT, CRIMPER	49
2	21024-5	WASHER, LOCK (NO 10) SHEAR PLATES	134	1	690501-3	CAM, Post FEED 1 1/8 STROKE	48
REF	21024-5	WASHER, LOCK (NO 10) FEED ROD GUIDE	133				47
4	21024-4	WASHER, LOCK (NO 8) STRIP GUIDE	132				46
2	21024-4	WASHER, LOCK (NO 8) SHEAR BLADE	131	1	690191-1	PLUG, NYLON	45
			130	1	455674-1	RAM	44
Z	21018-4	NUT, HEX MACH (4-40) DRAG	129	1	690125-1	WASHER, LAMINATED	43
REF	21068-5	NUT, HEX MACH (6-32) FD ADJ PLATE	128	1	690124-1	WASHER, RAM	42
			127				41
Z	21022-2	NUT, HEX SELF-LKG (8-32) DRAG STUD	126	Z	23241-6	BALL, STEEL	40
			125	Z	690170-1	SPRING, COMPRESSION	39
			124	1	690142-1	DISC, INSULATION	38
Z	4-21078-8	SCR, SKT HD SHLD (250 DIA X 1.00) DRAG	123	1	690141-8	DISC, WIRE	37
1	21009-2	SCR, SKT SET (1/4-20 X 25) (LOC-WEL) RAM	122	1	22480-5	WASHER, SPRING	36
			121	1	690212-1	POST, RAM	35
1	1-21002-7	SCR, BTN HD SKT CAP (6-32 X .38) CAM	120				34
			119				33
REF	3-21064-2	SCR, RD HD MACH (6-32 X 1.50) FEED ADJ	118	1	458980-2	APPLICATOR, BASIC (SUB ASSY)	32
			117				31
2	2-21002-2	SCR, BTN HD SKT CAP (8-32 X .50) STRIPPER	116				30
REF	2-21002-9	SCR, BTN HD SKT CAP (10-32 X .75) HSG CAP	115				29
1	22733-8	SCR, BTN HD SKT CAP (8-32 X .38) (LOC-WEL) ANVIL	114	1	3-690451-2	SPACER, STRIPPER	28
4	3-21002-3	SCR, BTN HD SKT CAP (1/4-20 X .50) STR GDE PL	113	1	240639-1	STRIPPER	27
REF	2-22733-9	SCR, BTN HD SKT CAP (1/4-20 X .75) BASE PL	112	REF	455676-1	PLATE, BASE	26
			111	Z	22354-8	DRAG, STUD	25
			110	1	455678-1	PLATE, STRIP GUIDE	24
2	2-21000-4	SCR, SKT HD CAP (6-32 X 1.00) DRAG ADAPTOR	109				23
2	23030-1	SCR, SKT HD CAP (6-32 X .25) (LOC-WEL) CP DISC	108	Z	4-22281-1	SPRING, DRAG	22
3	2-21000-7	SCR, SKT HD CAP (8-32 X .50) SHEAR BLADE	107				21
1	2-21000-6	SCR, SKT HD CAP (8-32 X .38) STRIP GUIDE	106		240636-1	LEVER, DRAG	20
REF	2-21000-6	SCR, SKT HD CAP (8-32 X .38) STRIP GUIDE	105	1	454177-1	DRAG, STOCK	19
REF	3-21000-7	SCR, SKT HD CAP (10-32 X .75) FD ROD GUIDE	104	1	458030-5	GUIDE, STRIP (REAR)	18
REF	3-21000-9	SCR, SKT HD CAP (10-32 X 1.00) DRAG SPRING	103	1	458031-5	GUIDE, STRIP (FRONT)	17
REF	3-21000-6	SCR, SKT HD CAP (10-32 X .62) FD ADJ PLATE	102	REF	454178-1	GUIDE, FEED ROD	16
REF	3-21000-4	SCR, SKT HD CAP (10-32 X .38) PIVOT BLK	101	REF	4-22284-9	SPRING, FEED RETURN	15
Z	3-21000-8	SCR, SKT HD CAP (10-32 X .88) SHEAR PLATE	101				14
REF	455745-1	GUARD WINDOW	79				13
			78				12
			77				11
			76	1	240644-1	SPACER, HOLD DOWN	10
2	21017-2	SCR, DRIVE (#2 X .19) ID PLATE	75	2	1-240645-0	PLATE, REAR SHEAR	9
1	461264-1	PLATE, ID	74	1	240642-1	SPACER, SHEAR PLATE	8
REF	458109-1	WASHER, FLAT (SPECIAL)	73	1	5-238005-3	PLATE, FRONT SHEAR	7
Z	690603-1	SPRING, ASSIST	72	1	1-240651-6	ANVIL	6
REF	690517-1	SPACER	71				5
			70	1	240641-3	BLADE, SLUG	4
			69	1	238009-3	HOLD DOWN, TERMINAL	3
			68	1	2-456135-6	SPACER, SHEAR BLADE	2
			67	1	455888-3	SPACER, TUBULAR	1
			66	1	456408-5	CRIMPER, INSULATION	
			65				
			64				
			63				
			62				
			61				
			60				

CRIMPING DATA				APPLICATOR WILL APPLY	
PAD LTR	CRIMP HEIGHT	WIRE SIZE	WIRE STRIP LENGTH		
A	.069	16			60389
B	.063	18			60390
C	.059	20			60391 OBS.
D	NOT USED				
CRIMP	SIZE	TYPE	FEED	APPL INST	
WIRE	.110	F			
INSUL	.155	O	.860	A1	8039
WIRE RANGE	20-16	INSULATION RANGE	1.00-.140	PRESS NO	565435-5
REMARKS	AMP-O-LECTRIC POST FEED				

REMARKS		NO	REV
TO APPLY TERMINAL SPEC 114-2084			
APPL USED ON MACHINE PART NO	MACH SERIAL NO	DISTRIBUTION	
CUSTOMER NAME	APPL SERIAL NO	ORIGINAL	
ADDRESS	PURCHASE ORDER	CUSTOMER COPY	
CITY	ENG APP	FIELD ENG COPY	

SET UP PAGE 10-1
458638-11764

DR 12-11-74 APP 12/74
CHK 12-88
NAME: MINIATURE QUICK CHANGE APPLICATOR
END FEED (SPADE)

AMP INCORPORATED Harrisburg, Pa.

D NO 466211-4

REVISION RECORD

REV	DATE	DESCRIPTION
1	11-23	ECN 6150-1249-03
2	12-88	REV PER ECN 1165283
3	12/88	REV PER ECN R 5478
4	12/88	REV PER ECN R 2873
5	12/88	REV PER ECN R 2692

AMP 3076-2 REV 8-74