

| REVISIONS |     |               |             |       |       |
|-----------|-----|---------------|-------------|-------|-------|
| REV       | ECO | DESCRIPTION   | DATE        | BY    | APPR  |
| A1        | -   | FIRST RELEASE | Oct.30,2017 | White | Tommy |

NOTES: UNLESS OTHERWISE SPECIFIED

- MATERIAL:  
 INSULATION INSERT: PA66, UL94 V0  
 SEAL: VITON, EPDM  
 HOUSING BODY: ZINC DIE CAST, NICKEL PLATED  
 COUPLING NUT: COPPER ALLOY, NICKEL PLATED  
 CONTACT: COPPER ALLOY, GOLD PLATED
- SPECIFICATIONS:
  - CURRENT RATING: SIGNAL: 10 AMPS  
POWER: 30 AMPS
  - VOLTAGE RATING: SIGNAL: 250V AC/DC  
POWER: 630V AC/DC
  - CONTACT RESISTANCE: SIGNAL: <5 mOHMS  
POWER: <3 mOHMS
  - OPERATING TEMPERATURE: -20°C TO +130°C
  - DIELECTRIC WITHSTANDING VOLTAGE: LESS THAN 2 MILLIAMPS CURRENT LEAKAGE @ SIGNAL: 2500VOLTS AC.  
POWER: 6000 VOLTS AC.
  - DEGREE OF PROTECTION: IP67 ( MATED CONDITION )
  - DEGREE OF POLLUTION: 3 PER UL840
  - OVERVOLTAGE CATEGORY: III PER UL840
  - MATING CYCLE DURABILITY: >500 CYCLES
  - RoHS COMPLIANT

3. ALL DIMENSIONS ARE FOR REFERENCE USE ONLY.

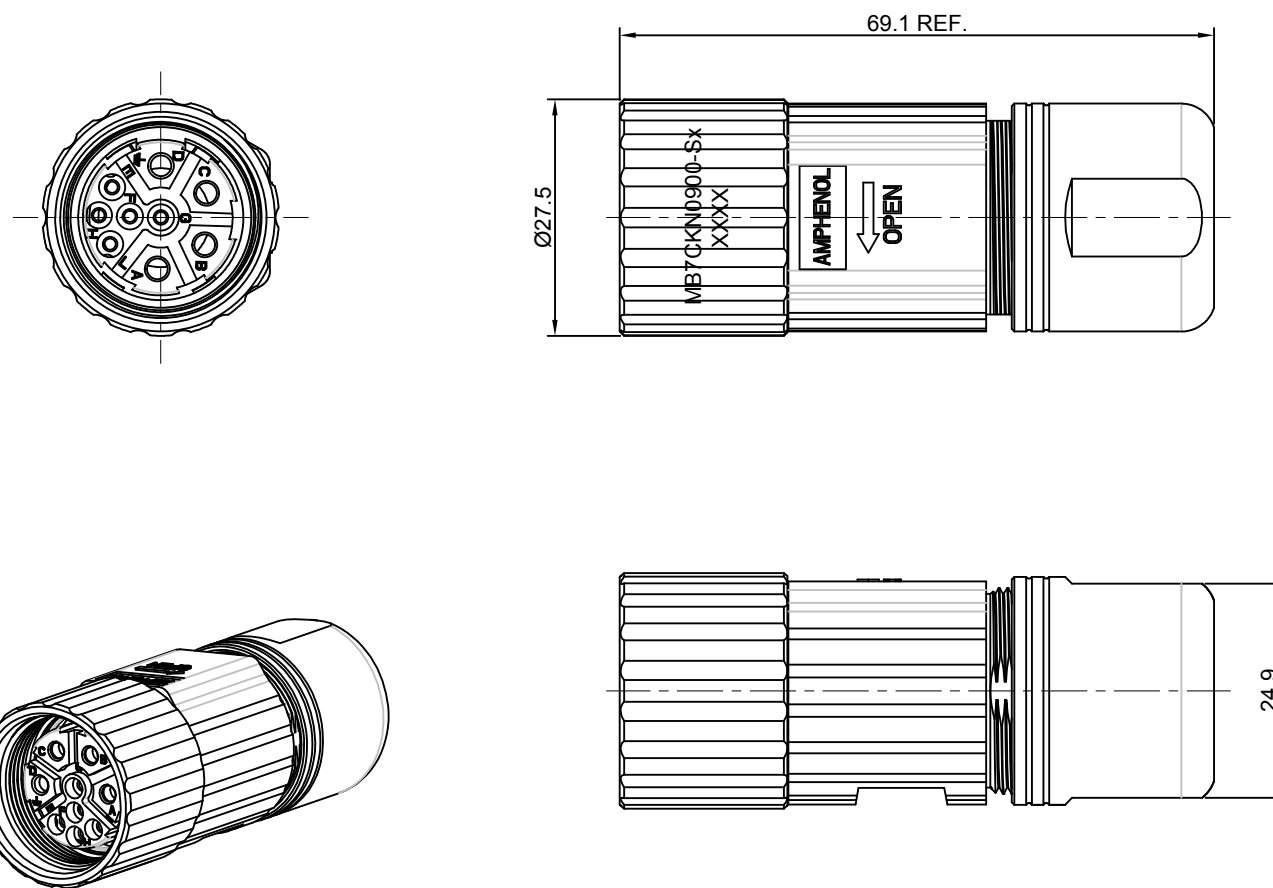

| Item | Part number       | Connector P/N | Cable OD Range |
|------|-------------------|---------------|----------------|
| 1    | MB7CKN0900-S1-KIT | MB7CKN0900-S1 | 7.5~11.0 mm    |
| 2    | MB7CKN0900-S2-KIT | MB7CKN0900-S2 | 11.0~14.5 mm   |
| 3    | MB7CKN0900-S3-KIT | MB7CKN0900-S3 | 14.5~17.0 mm   |

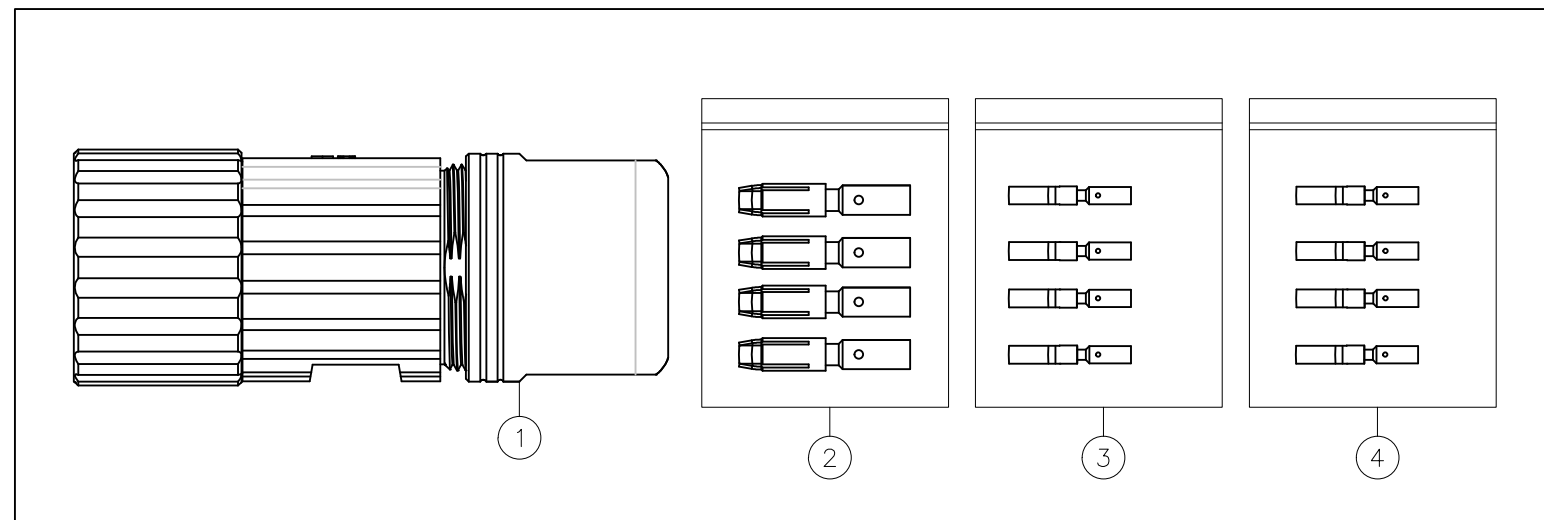

| 5        | SC000385      | Socket contact,1.0mm,Crimp 24~28AWG | 4    |
|----------|---------------|-------------------------------------|------|
| 5        | SC000259      | Socket contact,1.0mm,Crimp 18~22AWG | 3    |
| 4        | SC000260      | Socket contact,2.0mm,Crimp 14~18AWG | 2    |
| 1        | MB7CKN0900-Sx | CONNECTOR                           | 1    |
| QUANTITY | PART NUMBER   | DESCRIPTION                         | ITEM |

| MATERIALS LIST           |  |  |                         |
|--------------------------|--|--|-------------------------|
| SIGNATURES               |  | DATE   |                         |
| DRAWN: White             |  | Oct.30,17  |                         |
| CHECKED: Tod             |  | Oct.30,17  |                         |
| ENGINEER:                |  |  |                         |
| APPROVAL: Tommy          |  | Oct.30,17  |                         |
| MATERIAL SPECIFICATIONS: |  | CUSTOMER:  |                         |
| PROCESS SPECIFICATIONS:  |  | THIS DRAWING IS SUPPLIED FOR INFORMATION ONLY. DESIGN FEATURES, SPECIFICATIONS AND PERFORMANCE DATA SHOWN HEREON ARE THE PROPERTY OF THE AMPHENOL CORPORATION. NO RIGHTS OF REPRODUCTION ARE IMPLIED. ALL DIMENSIONS ARE SUBJECT TO NORMAL MANUFACTURING VARIATIONS. |                         |
| NEXT ASSY:               |  | SIZE: B C-   | TYPE: MB7CKN0900-Sx-KIT |
|                          |  | SCALE: NONE  | REVISION: A1            |

**Amphenol**  
 Sine Systems - www.amphenol-sine.com  
 44724 Morley Drive  
 Clinton Township, MI 48036

**KIT;M23B,PLUG,STRAIGHT,9(4+5)POS**

SHEET 1 OF 1

TITLE: KIT;M23B,PLUG,STRAIGHT,9(4+5)POS

DWG NO: MB7CKN0900-Sx-KIT

REV: A1

SH: 1 OF: 1