

- NOTES
1. MATERIAL : BRASS , 0.45mm THICKNESS
 2. PART NO. AND FINISH

PART NO.	MATERIAL NO.	FINISH	TRADE MARK
35725-2400	357252400	UNPLATED	MK2
35725-2411	357252411	POST PLATED TIN	H MK2
35725-2410	357252410	POST PLATED TIN	MK2

H (TRADE MARK) : HIGH TENSION TIN-PLATED PRODUCT

3. APPLICABLE WIRE RANGE : AWG #18 - #14
4. RECOMMENDED LENGTH OF WIRE STRIP IS 6.0-6.8mm

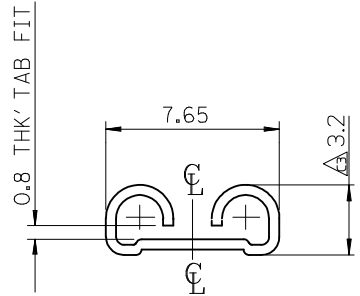

VIEW "A"

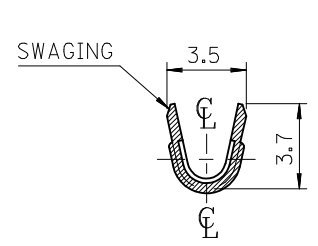

SEC' : B-B''

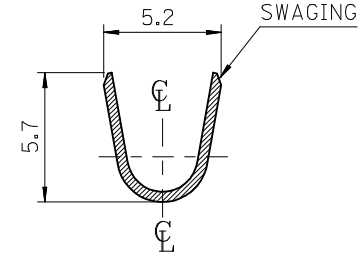

SEC' : C-C''

CHANGED DIMENSION EC NO: KTR2012-0066 DRWN:HIM00N 2012/04/25 CHKD:BCY00N 2012/04/25 APPR:DC_LISLE 2012/06/29	QUALITY SYMBOLS	GENERAL TOLERANCES (UNLESS SPECIFIED)	DIMENSION STYLE	SCALE	DESIGN UNITS	THIRD ANGLE PROJECTION	
	▼=0 □=0	mm INCH 4 PLACES ± --- ± --- 3 PLACES ± --- ± --- 2 PLACES ± 0.20 ± --- 1 PLACE ± 0.3 ± --- ANGULAR ± ---°	MM ONLY	4.5:1	METRIC		
	DRAWN BY: HIM00N DATE: 2012/04/25 CHECKED BY: BCY00N DATE: 2012/04/25 APPROVED BY: DATE:	DRAFT WHERE APPLICABLE MUST REMAIN WITHIN DIMENSIONS		TITLE	.250 SLIP-ON RECEPTACLE TERMINAL (SLOT TYPE)		
	MATERIAL NO. DOCUMENT NO. SHEET NO.	SEE TABLE		MOLEX INCORPORATED			