

COUNT	DESCRIPTION OF REVISIONS	BY	CHKD	DATE	COUNT	DESCRIPTION OF REVISIONS	BY	CHKD	DATE
1					1				
2					2				
3					3				

REELED DIMENSION (FREE)

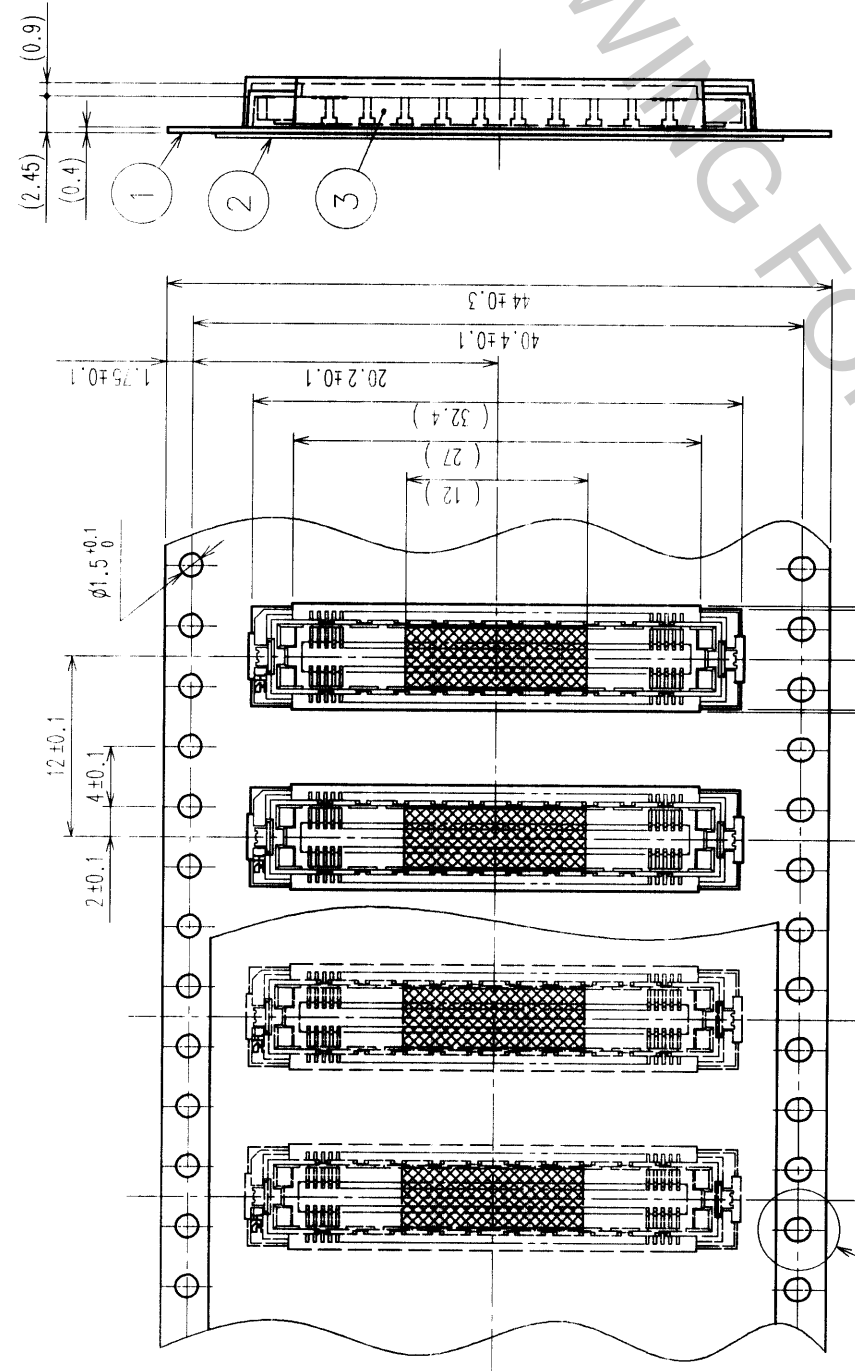

THE DIRECTION OF PULLING OUT →

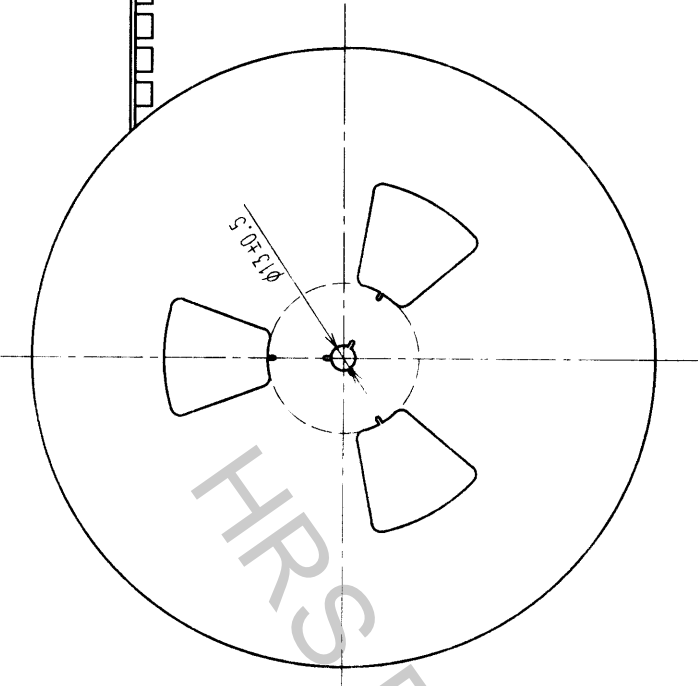

A (5:1)

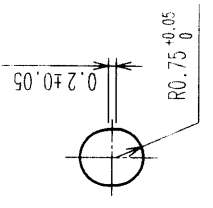

DETAIL FOR VACUUM PICKUP (5:1)

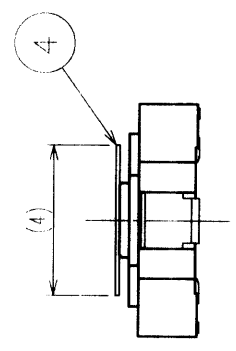

- NOTES 1 REEL: 1000 CONNECTORS.
- 2 MINIMUM 10 COMPARTMENTS FROM BOTH REEL ENDS REMAIN EMPTY.
- 3 THIS PRODUCT HAS NO POLARITY TO TAPE AND REEL PACKAGING.

2	PET	TOP COVER TAPE	4	POLYIMIDE	(TAPE FOR VACUUM PICKUP)
1	PS	EMBOSSED CARRIER TAPE	3	(CONNECTOR)	
NO.	MATERIAL	FINISH, REMARKS	NO.	MATERIAL	FINISH, REMARKS
DRAWING FOR PACKING					
CODE NO. (OLD)		DRAWN		CHECKED	APPROVED
CL		 M. Matsubara 20.01.15		 Y. Shimizu 20.01.17	RELEASED 20.01.17
DRAWING NO.		PART NO.		REMARKS	
EDC3-152645-02		FX11B-100S-SV(22)			
SCALE		CODE NO.		UNITS	
2 : 1		CL573-0753-0-22		mm	
UNITS		HIROSE ELECTRIC CO., LTD		8	

TO	
PCK	